

EAHP2018

19th MEETING OF THE EUROPEAN ASSOCIATION FOR HAEMATOPATHOLOGY

FINAL PROGRAMME



Picture credit: © surangaw - Fotolia.com

Edinburgh, Scotland, UK
29 September – 4 October 2018

www.eahp-sh2018.com

Imprint

Editors

European Association for Haematopathology

Local Congress Chair 2018

Dr. John Goodlad
Glasgow, UK

Legal Organiser (PCO)

MCI Deutschland GmbH
MCI | Germany – Berlin
Markgrafenstr. 56
10117 Berlin, Germany

Congress Website

www.eahp-sh2018.com

Date of Publishing

10 September 2018

The programme indicated may be subject to change.

Table of Contents

Congress Information

Committees	4
Welcome Address	5
Information from A to Z	6
Networking Dinner	7

Scientific Programme

Programme Overview	8
Location Plan	10
Saturday, 29 September 2018	11
Sunday, 30 September 2018	13
Monday, 1 October 2018	19
Tuesday, 2 October 2018	23
Wednesday, 3 October 2018	27
Thursday, 4 October 2018	33

Poster Presentations

Bone Marrow	37
Lymphoma	40

Exhibition and Sponsoring

Acknowledgements	55
Sponsored Satellite Symposia	56
Exhibition Floor Plan	58

Committees

Chair, Local Organising Committee

John Goodlad

Department of Pathology, Level 3
Laboratory Medicine Building
Queen Elizabeth University Hospital
1345 Govan Road | Glasgow, G51 4TF

Executive Committee

Dan Arber, United States

Christiane Copie-Bergman, France

Daphne de Jong, The Netherlands

Stephan Dirnhofer, Switzerland

Falko Fend, Germany

John Goodlad, United Kingdom

Margarita Guenova, Bulgaria

Marja-Liisa Karjalainen-Lindsberg, Finland

Santiago Montes Moreno, Spain

German Ott, Germany

Maurilio Ponzoni, Italy

Leticia Quintanilla De Fend, Germany

Birgitta Sander, Sweden

Andrew Wotherspoon, United Kingdom

Lymphoma Workshop Panel Members

Maria Calaminici, United Kingdom

Snjezana Dotic, Croatia

Judith Ferry, United States

John Goodlad, United Kingdom

Rebecca King, United States

Santiago Montes Moreno, Spain

Ilse Oschlies, Germany

German Ott, Germany

Maurilio Ponzoni, Italy

Alexandra Traverse-Glehen, France

Bone Marrow Workshop

Panel Members

Dan Arber, United States

Ayoma Attygalle, United Kingdom

Falko Fend, Germany

Peter Johnston, United Kingdom

Camille Laurent, France

Alberto Zamo, Italy

Legal Organiser (PCO)

MCI Deutschland GmbH

MCI | Germany – Berlin

Markgrafenstr. 56 | 10117 Berlin, Germany

T: +49 30 204590

F: +49 30 2045950

eahp@mci-group.com

Project Management

Amira Hussein

eahp@mci-group.com

Registration

Stephanie Kante

registration.berlin@mci-group.com

Industrial Exhibiton, Symposia

and Sponsoring

Gino Thiel

eahp-sponsoring@mci-group.com

Welcome Address



Dear colleagues and friends,

On behalf of the European Association for Haematopathology (EAHP) and the Society for Hematopathology (SH), as chair of the local organising committee, it gives me great pleasure to invite you to Edinburgh, Scotland, for the 19th Meeting of the EAHP. This will be held from 29 September to 4 October 2018 at the Edinburgh International Conference Centre (EICC). The EICC is a state of the art purpose built conference facility situated in the heart of the city, close to Edinburgh, which is one of the oldest and most beautiful cities in Europe with a unique atmosphere. A UNESCO World Heritage site, it is steeped in history and filled with many ancient buildings, yet combines this with the sights, sounds and tastes of a diverse, vibrant, modern city. The local organising committee is working hard to provide an exciting social programme that will introduce you to some of what Edinburgh has to offer. Edinburgh is a compact city, easy to explore on foot. Tours and social events will also be available to help participants more fully experience the city and surrounding areas. I am confident that this meeting will be an outstanding event, both professionally and socially. Updates on the congress will be regularly provided on the homepage.

“Ceud Mile Fáilte”

John Goodlad

Chair local organiser

On behalf of the organising committee

Information from A to Z

Registration

The registration desk is situated on the Ground floor in the Strathblane Hall.

Registration Opening Hours

Saturday, 29 September	12.30–17.30
Sunday, 30 September	7.00–19.00
Monday, 1 October	7.00–17.30
Tuesday, 2 October	7.00–18.30
Wednesday, 3 October	8.00–18.00
Thursday, 4 October	8.00–16.00

Congress Venue

Edinburgh International Conference Centre
The Exchange Edinburgh
150 Morrison St | Edinburgh, UK

Abstract Publishing

Abstracts will be published online in an eBook available at www.eahp-sh2018.com.

Catering

The catering stations for the coffee and lunch breaks are located in the exhibition on Level -2 in the Cromdale Hall. Lunch and coffee breaks are included in the registration fee.

Certificate of Attendance

Certificates will be sent to you two weeks after the congress by e-mail for processing with the national authority in your country of practice.

Cloakroom

The cloakroom is situated on the Ground floor.

Cloakroom Opening Hours

Saturday, 29 September	12.30–18.30
Sunday, 30 September	7.00–19.00
Monday, 1 October	7.00–17.30
Tuesday, 2 October	7.00–18.30
Wednesday, 3 October	8.00–18.00
Thursday, 4 October	8.00–16.00

CME Accreditation

The 19th EAHP Meeting was granted 34 European CME credits by the European Accreditation Council for Continuing Medical Education (EACCME). European “CME” credits can be converted to the US CME Credits. Please visit the website of American Medical Association (www.ama-assn.org).

Helpful Numbers

Ambulance:	999
Fire service:	999
Police:	999
Taxi:	0131 229 2468

Exhibition Hours

Saturday, 29 September	13.00–20.30
Sunday, 30 September	8.30–18.30
Monday, 1 October	8.30–18.30
Tuesday, 2 October	8.30–16.00

Internet – WiFi

Name: EAHP2018
Password: edinburgh

Language

The official language of the congress is English. Simultaneous translation will not be provided.

Speaker's Presentation Centre

The speaker's presentation centre is located in room Soutra on the Ground floor. Speakers are requested to hand in their presentations (including all media files and embedded fonts) on a USB-stick at least 2 hours before their talk. Speakers having a presentation during the first time slot in the morning are asked to hand in their slides the day before. Technicians will assist with the upload of your files and provide the opportunity to preview and/or edit the presentation if necessary. Please allow

Information from A to Z

enough time for potential trouble shooting. If you are unavoidably delayed, you must still go directly to the speakers presentation centre. All presentations must be run via the central media system. Personal laptops cannot be connected to it.

Speakers Presentation Centre Opening Hours

Saturday, 29 September	12.30–17.30
Sunday, 30 September	7.00–18.00
Monday, 1 October	7.00–16.30
Tuesday, 2 October	7.00–17.30
Wednesday, 3 October	8.00–17.00
Thursday, 4 October	8.00–15.30

Name Badge

The name badge will be the official ticket and should be worn at all times in order to access meeting rooms and exhibition halls. In case of lost or forgotten badges an administration fee of € 10 will be charged.

Programme Changes

The organiser reserves the right to make changes if necessary. No full or partial refunds are made to the attendees in the event of cancellations or other changes in the programme. Please note that changes will be posted at the registration desk and at the entrance of the session halls.

Photography, Audio, Video and Mobile Phone Policy

Audio, photo and video recording by any device (e.g. cameras, laptops, PDAs, mobile phones, watches) is strictly prohibited during all oral and poster sessions, unless prior permission is obtained from the congress organiser. Mobile phones must be in silent mode while attending sessions.

Networking Dinner

Tuesday, 2 October 2018
20.00–23.00

National Museum of Scotland

The diverse collections will take you on a journey of discovery through the history of Scotland and around the world, taking in the wonders of nature, art, design and fashion and science and technology – all under one roof.

Address

Chambers Street
Edinburgh
EH1 1JF

How to get there

The National Museum is within 20 minutes walking distance from the Convention Center Edinburgh. The nearest train station is Edinburgh Waverley. A number of buses go via the city centre and stop outside the museum on Chambers Street, or nearby on George IV Bridge and South Bridge.

Tickets

€ 100 per ticket including buffet and drinks

For Package registrations and accompanying person tickets are included, if you are marked to participate.

Programme Overview

- EAHP Lymphoma Symposium
- EAHP Lymphoma Workshop
- Parallel Session
- Keynote Lecture
- Educational Session
- Poster Presentations
- Bone Marrow Symposium and Workshop
- Satellite Symposium
- Miscellaneous

Congress Information

Congress Information

SAT

SAT

SUN

SUN

MON

MON

TUE

TUE

WED

WED

THU

THU

Poster Presentations

Poster Presentations

Exhibition and Sponsoring

Exhibition and Sponsoring

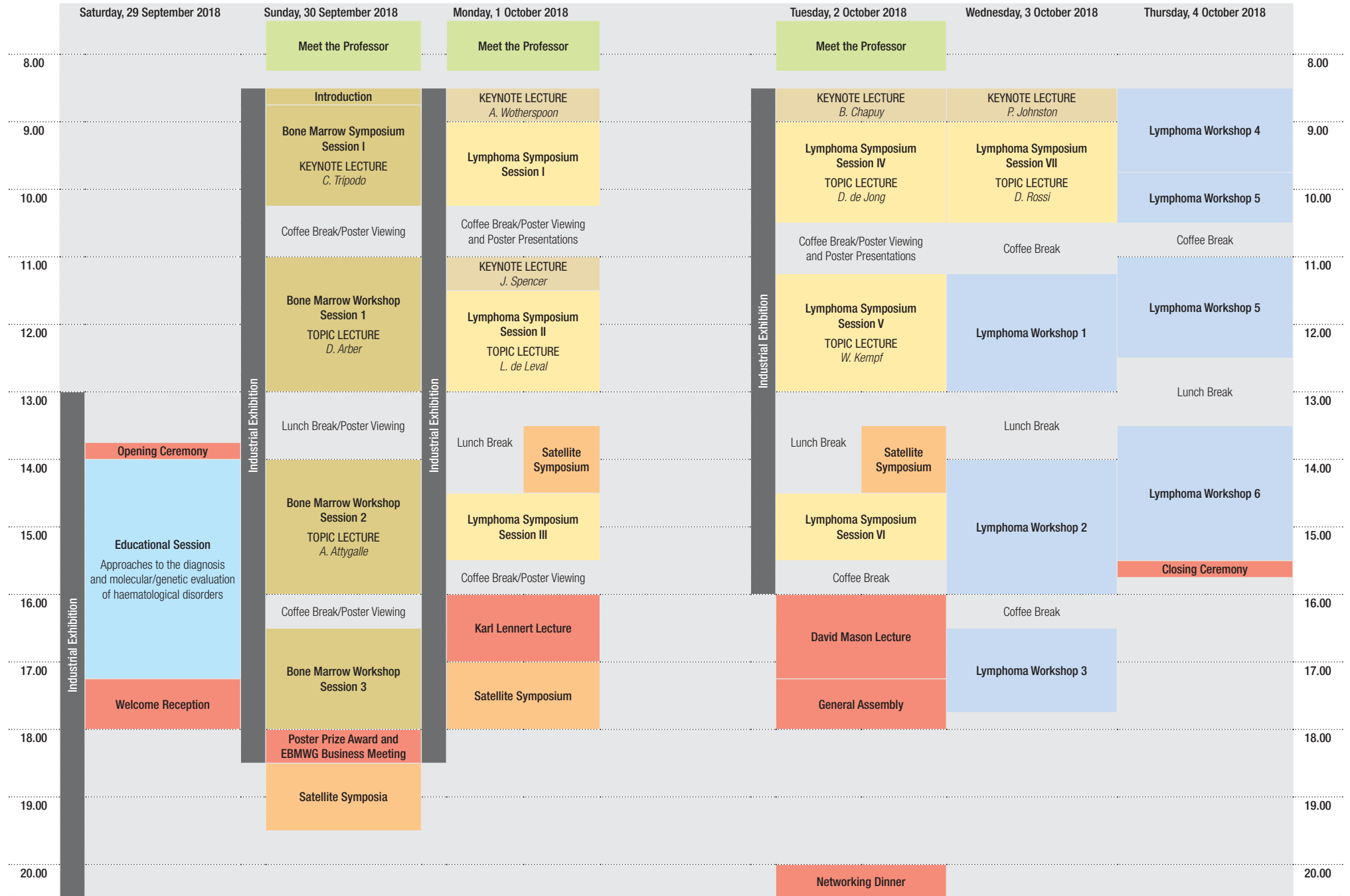

Edinburgh International Conference Centre

Level 3

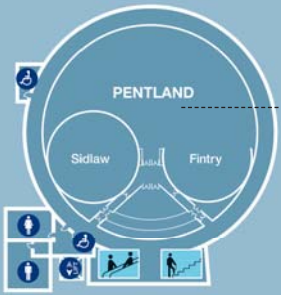

→ **Pentland**
Plenary Room

Level 1



→ **Carrick/Harris**
Meet the Professor (Breakout Rooms)

Level 0



→ **Soutra**
Speaker's Presentation Centre

→ **Strathblane Hall**
Registration Desk

Level -2



→ **Cromdale Hall**
Industrial Exhibition

Saturday
29 September 2018

Pentland Auditorium

13.45–14.00 **Opening Ceremony**

Pentland Auditorium

EDUCATIONAL SESSION

14.00–17.15 **Approaches to the diagnosis and molecular/genetic evaluation of haematological disorders**

Chairs: A. Wotherspoon, D. Arber

14.00–14.45 My approach to the diagnosis of extranodal B-cell lymphoproliferations
*A. Wotherspoon*14.45–15.30 My approach to the diagnosis of extranodal non-cutaneous T-cell lymphoproliferations
L. Quintanilla-Fend

15.30–16.00 Coffee Break

16.00–16.30 My approach to the use of molecular and genetic studies in the evaluation of lymphoid neoplasms
*T. Molina*16.30–17.00 My approach to the use of molecular and genetic studies in the evaluation of myeloid neoplasms
*R. Hasserjian***17.00–17.15** **Remembering Frank Kuo**

Cromdale Hall, Level -2

17.15–18.00 **Welcome Reception**

Sunday
30 September 2018

Scientific Programme

Sunday, 30 September 2018

PARALLEL SESSION	
7.30–8.15	Meet the Professor
7.30–8.15 Carrick 1 & 2	Getting comfortable in the grey: Dealing with myeloid cases falling between existing diagnostic categories <i>A. Orazi</i>
7.30–8.15 Harris 1	From clinic to molecular: Integration of all modalities in daily lymphoma diagnostics <i>D. de Jong</i>
7.30–8.15 Harris 2	A day in the life of a haematopathologist: Challenges and solutions <i>S. H. Swerdlow</i>
7.30–8.15 Carrick 3	Molecular genetics: Helping pathologists in routine diagnosis <i>E. Campo</i>
Pentland Auditorium	SESSION I
8.30–10.10	Bone Marrow Symposium
	Chairs: U. Gianelli, A. Orazi
8.30–8.40	Introduction <i>F. Fend and P. Johnston</i>
8.40–9.10	Keynote lecture: The role of the bone marrow microenvironment in lymphoma <i>C. Tripodo</i> Chairs: A. Tzankov, M. Czader
9.10–9.25	BMS-0-1 Bone marrow infiltration of angioimmunoblastic T-cell lymphoma: morphologic patterns and ancillary phenotypic analyses <i>M. Gerlach</i>
9.25–9.40	BMS-0-2 The oncogenic role of IGF1R mutations in multiple myeloma <i>E. Leich-Zbat</i>
9.40–9.55	BMS-0-3 RUNX1 mutations can lead to aberrant expression of CD79a and PAX5 in acute myelogenous leukemias: a potential diagnostic pitfall <i>A. Tzankov</i>
9.55–10.10	BMS-0-4 Myeloid neoplasms arising in chronic lymphocytic leukemia or other indolent B-cell lymphomas in bone marrow: An intrinsic predisposition due to altered microenvironment or a therapy-related direct genetic insult? <i>L. Yang</i>
10.10–11.00	Coffee Break and Poster Viewing

Scientific Programme

Sunday, 30 September 2018

Pentland Auditorium	BONE MARROW WORKSHOP SESSION 1
11.00–13.00	ALL and reactive lesions
	Chairs: D. Arber, P. Johnston
11.00–11.30	Topic Lecture: What's new in ALL – the 2016 WHO update <i>D. Arber</i>
11.30–11.35	Session Introduction
11.35–11.45	EAHP18-BMWS-411 TdT positive high-grade B-cell lymphoma with MYC, BCL2 and BCL6 rearrangements <i>E. Gudgin</i>
11.45–11.55	EAHP18-BMWS-132 B-lymphoblastic leukemia/lymphoma associated with t(8;22)(p11.2;q11.2)/BCR-FGFR1 rearrangement <i>A. Bogusz</i>
11.55–12.05	EAHP18-BMWS-152 B-lymphoblastic leukemia/lymphoma with MYC and BCL2 rearrangements, arising from follicular lymphoma <i>J. Geyer</i>
12.05–12.15	EAHP18-BMWS-266 5-month-old with acute T-lymphoblastic leukemia (TRA-MYC rearrangement) <i>L. Zhang</i>
12.15–12.25	EAHP18-BMWS-351 Recurrence and lineage switch of a B-cell lymphoblastic leukemia as a myeloblastic leukemia in the skin of a 15-year-old boy <i>O. Weinberg</i>
12.25–12.35	EAHP18-BMWS-258 Hyaline-vascular Castleman changes in the setting of anaemia, thrombocytopenia, organomegaly and marrow fibrosis <i>P. Martin-Cabrera</i>
12.35–13.00	Session Summary
13.00–14.00	Lunch Break and Poster Viewing

Scientific Programme

Sunday, 30 September 2018

Pentland Auditorium	BONE MARROW WORKSHOP SESSION 2
14.00–16.00	T-NHL and Hodgkin Lymphoma
	Chairs: A. Attygalle, C. Laurent
14.00–14.30	Topic Lecture: T-cell lymphomas in the bone marrow <i>A. Attygalle</i>
14.30–14.35	Session Introduction
14.35–14.45	EAHP18-BMWS-102 Primary bone marrow Anaplastic Large Cell Lymphoma, ALK negative and reactive haemophagocytic syndrome <i>A. Ruskova</i>
14.45–14.55	EAHP18-BMWS-217 Aggressive cytotoxic T-cell lymphoma following successful therapy of CLL <i>Z. Rudzki</i>
14.55–15.05	EAHP18-BMWS-284 EBV Negative Aggressive NK-Cell Leukemia with Bone Marrow Presentation <i>A. Chiu</i>
15.05–15.15	EAHP18-BMWS-389 Intravascular bone marrow infiltration by indolent gamma/delta T-cell lymphoma <i>M. Pizzi</i>
15.15–15.25	EAHP18-BMWS-555 Bone marrow involvement by an angioimmunoblastic T-cell lymphoma obscured by a polytypic plasma cell proliferation <i>P. Gaulard</i>
15.25–15.35	EAHP18-BMWS-289 Hodgkin Lymphoma with primary presentation as pancytopenia and marrow involvement <i>T. Shet</i>
15.35–16.00	Session Summary
16.00–16.30	Coffee Break And Poster Viewing

Scientific Programme

Sunday, 30 September 2018

Pentland Auditorium	BONE MARROW WORKSHOP SESSION 3
16.30–18.00	Aggressive B-NHL
	Chairs: F. Fend, A. Zamo
16.30–16.35	Session Introduction
16.35–16.45	EAHP2018-BMWS-255 De novo CD5 positive diffuse large B-cell lymphoma of the bone marrow <i>A. Saleem</i>
16.45–16.55	EAHP2018-BMWS-279 Primary bone marrow presentation of a high-grade B-cell lymphoma with MYC and BCL2 rearrangements and blastoid features <i>K. Ganapathi</i>
16.55–17.05	EAHP2018-BMWS-296 Primary bone marrow high grade B cell lymphoma with MYC and BCL6 gene rearrangement <i>G. Leopold</i>
17.05–17.15	EAHP2018-BMWS-300 Diffuse large B-cell lymphoma with massive involvement of the bone marrow and spleen <i>L. de Leval</i>
17.15–17.25	EAHP2018-BMWS-385 Burkitt lymphoma lacking MYC rearrangements and 11q aberrations in bone marrow <i>K. Petrova-Dus</i>
17.25–17.35	EAHP2018-BMWS-429 Nodular Lymphocyte Predominant Hodgkin Lymphoma presenting in the bone marrow <i>R. Jackson</i>
17.35–18.00	Session Summary
Pentland Auditorium	
18.00–18.30	Poster Prize Award and EBMWG Business Meeting

PARALLEL SESSION

7.30–8.15	Meet the Professor
7.30–8.15 Carrick 1 & 2	Getting comfortable in the grey: Dealing with myeloid cases falling between existing diagnostic categories <i>A. Orazi</i>
7.30–8.15 Carrick 3	EBV-associated lesions: Management of diagnostic problems <i>E. S. Jaffe</i>
7.30–8.15 Harris 2	Moving beyond the primary diagnosis: Challenges in progressed and “treated” haematologic neoplasms <i>R. Hasserjian</i>
7.30–8.15 Harris 1	Molecular genetics: Helping pathologists in routine diagnosis <i>E. Campo</i>
Pentland Auditorium	
8.20–8.30	Welcome
G. Ott and J. Goodlad	
Pentland Auditorium	
8.30–9.00	The MALT lymphoma concept
A. Wotherspoon	
Pentland Auditorium	
9.00–10.15	Lymphoma Symposium
Chairs: J. Goodlad, G. Ott	
9.00–9.15	LYS-0-1-1 Novel GPR34 and CCR6 mutation and distinct genetic profiles in MALT lymphomas of different sites <i>M.-Q. Du</i>
9.15–9.30	LYS-0-1-2 High-throughput sequencing of nodal marginal zone lymphomas identifies recurrent BRAF mutations <i>D. Juskevicius</i>
9.30–9.45	LYS-0-1-3 Clonality assessment of disseminated MALT lymphoma <i>F. Climent</i>
9.45–10.00	LYS-0-1-4 Primary CNS Small B-cell Neoplasms <i>L. Nomani</i>
10.00–10.15	Poster Review: Introduction and overview <i>E. Sabattini, M. Guenova, S. Rodig</i>

10.15–11.00	Coffee Break, Poster Presentations and Poster Viewing
Pentland Auditorium	KEYNOTE LECTURE
11.00–11.30	Factors linked to intrinsic lymphocyte biology and the microenvironment in site-specific lymphomagenesis
J. Spencer	
Pentland Auditorium	
11.30–13.00	Lymphoma Symposium
Chairs: C. Copie-Bergman, G. Bhagat	
11.30–12.00	Topic Lecture: Gastrointestinal T-cell lymphomas <i>L. de Leval</i>
Chairs: M.-L. Karjalainen-Lindsberg, E. Hsi	
12.00–12.15	LYS-0-2-1 DLBCL: Microenvironmental signature along with COO identifies different risk groups <i>F. Melle</i>
12.15–12.30	LYS-0-2-2 PDL1 and PDL2 expression in primary diffuse large B-Cell lymphoma (DLBCL) of the CNS <i>M. Abdulla</i>
12.30–12.45	LYS-0-2-3 The tumor microenvironment in Primary Central Nervous System Lymphoma <i>L. Marcelis</i>
12.45–13.00	LYS-0-2-4 The microenvironmental landscape of extranodal natural killer/ T-cell lymphoma <i>J. Cho</i>
13.00–14.30	Lunch and Satellite Symposium

Pentland Auditorium SESSION III

14.30–15.30 Lymphoma Symposium

Chairs: M. Narbaitz, O. Weinberg

14.30–14.45 LYS-0-3-1
 Mutational landscape of extranodal NK/T-cell lymphoma, nasal type from Latin America
I. Montes-Mojarro

14.45–15.00 LYS-0-3-2
 NKp46 is a useful diagnostic biomarker in gastrointestinal T-cell lymphoproliferative diseases and constitutes a therapeutic target. A CELAC network study
J. Bruneau

15.00–15.15 LYS-0-3-3
 Angioimmunoblastic T-cell lymphoma contains multiple clonal T-cell populations derived from a common TET2 mutant progenitor cell
M.-Q. Du

15.15–15.30 LYS-0-3-4
 Angioimmunoblastic T-cell Lymphoma and Chronic Myelomonocytic Leukemia: a non-fortuitous association arising from precursor hematopoietic cells with acquired TET2 mutations
P. Gaulard

15.30–16.00 Coffee Break

Pentland Auditorium

16.00–17.00 Karl Lennert Lecture

M. Piris

Tuesday
2 October 2018

PARALLEL SESSIONS

7.30–8.15**Meet the Professor**

- 7.30–8.15
Carrick 3
EBV-associated lesions: Management of diagnostic problems
E. S. Jaffe
- 7.30–8.15
Harris 1
Moving beyond the primary diagnosis: challenges in progressed and “treated” haematologic neoplasms
R. Hasserjian
- 7.30–8.15
Carrick 1 & 2
From clinic to molecular: integration of all modalities in daily lymphoma diagnostics
D. de Jong
- 7.30–8.15
Harris 2
A day in the life of a haematopathologist – challenges and solutions
S. H. Swerdlow

Pentland Auditorium

KEYNOTE LECTURE

8.30–9.00**Genetic features of primary CNS lymphoma**

B. Chapuy

Pentland Auditorium

SESSION IV

9.00–10.30**Lymphoma Symposium**

Chairs: B. Sander, D. Gratzinger

- 9.00–9.30
Topic Lecture: Lymphoproliferative disorders in immune privileged sites other than CNS and testis
D. de Jong
- 9.30–9.45
LYS-0-4-1
Gene Expression Profile distinguishes Breast Implant-Associated Anaplastic Large Cell lymphoma from other Peripheral T-cell Lymphomas
A. Di Napoli
- 9.45–10.00
LYS-0-4-2
The role of PD-1 and PD-L1 in T-cell immune suppression in patients with primary testicular diffuse large B-cell lymphoma (PT-DLBCL)
M. R. Ambrosio
- 10.00–10.15
LYS-0-4-3
Next generation sequencing of vitreoretinal B-cell lymphoma reveals a mutational landscape similar to primary central nervous system lymphoma and facilitates diagnosis
I. Bonzheim
- 10.15–10.30
Poster Review: Poster prize award
E. Sabattini, M. Guenova, S. Rodig

10.30–11.15**Coffee Break, Poster Presentations and Poster Viewing**

Pentland Auditorium

SESSION V

11.15–13.00**Lymphoma Symposium**

Chairs: P. Jansen, S. Song

- 11.15–11.45
Topic Lecture: The importance of clinical correlation in cutaneous lymphoma
W. Kempf
- 11.45–12.00
LYS-0-5-1
Localized low-stage follicular lymphomas exhibit distinct biological/genetic features
H. Horn
- 12.00–12.15
LYS-0-5-2
Frequency of potential N-glycosylation sites in t(14;18)-positive and negative low and high stage follicular lymphoma
E. Leich-Zbat
- 12.15–12.30
LYS-0-5-3
Reproducibility of MYC protein expression scoring and impact on the prognosis of aggressive B-cell lymphoma patients
M. R. Ambrosio
- 12.30–12.45
LYS-0-5-4
Mutations analysis as an aid to separate diffuse large b-cell lymphoma subgroups according to the cell of origin
A. Mayer
- 12.45–13.00
LYS-0-5-5
Engagement of RelA, cRel or RelB NF-kB subunit activation impacts on classification and prognosis of diffuse large B-cell lymphoma
D. Collares

13.00–14.30**Lunch and Satellite Symposium**

Pentland Auditorium SESSION VI

14.30–15.30 Lymphoma Symposium

Chairs: S. Dojcinov, J. Geyer

14.30–14.45

LYS-0-6-1

THRLBCL immune transcriptomic profile displays high expression of inhibitory receptors and tolerogenic molecules
V. Tabanelli

14.45–15.00

LYS-0-6-2

JUNB, DUSP2, SGK1, CREBBP and SOCS1 are frequently mutated in T-cell/histiocyte rich large B-cell lymphoma
S. Hartmann

15.00–15.15

LYS-0-6-3

FBXO11 is a frequently mutated oncosuppressor in Burkitt Lymphoma
C. Pighi

15.15–15.30

LYS-0-6-4

Burkitt-like lymphoma with 11q aberration: A germinal center-derived lymphoma without ID3-TCF3-CCND3 pathway deregulation
B. Gonzalez-Farre

15.30–16.00 Coffee Break and Poster Viewing

Pentland Auditorium

16.00–17.15 David Mason Lecture

16.00–16.15 David Mason Awardee Lecture

16.15–17.15 The role of immunotherapy in solid oncology
J. Haanen

Pentland Auditorium

17.15–18.00 General Assembly**20.00–23.00 Networking Dinner**

National Museum of Scotland –
please refer to page 7 for further details – tickets required

Wednesday
3 October 2018

Pentland Auditorium	KEYNOTE LECTURE
8.30–9.00	Management of localized lymphoma in extranodal sites
	P. Johnson
Pentland Auditorium	SESSION VII
9.00–10.30	Lymphoma Symposium
	Chairs: S. Dirnhofer, F. Kuo †, M. Czader
9.00–9.30	Topic Lecture: The potential for liquid biopsy in lymphoma <i>D. Rossi</i>
9.30–9.45	LYS-0-7-1 Simultaneous analysis of mutations, translocations and copy number aberrations in B-cell Non-Hodgkin Lymphomas using an “All-in-One Next-Generation Sequencing Assay” <i>G. Tjitske Los-de Vries</i>
9.45–10.00	LYS-0-7-2 Use of T-cell-specific RNA in situ hybridisation as a novel test to distinguish malignant (lymphomatous) and benign (inflammatory) T cell infiltrates <i>E. Soilleux</i>
10.00–10.15	LYS-0-7-3 MiR-146a target gene CD147 regulates energy metabolism and promotes tumor growth, angiogenesis and invasion of ALK+ ALCL <i>J. Steinhilber</i>
10.15–10.30	LYS-0-7-4 Genetic evolution of clonally related in situ follicular neoplasia to diffuse large B-cell lymphoma of germinal center subtype <i>A. Vogelsberg</i>
10.30–11.00	Coffee Break

Pentland Auditorium	LYMPHOMA WORKSHOP SESSION 1
11.00–13.00	Primary cutaneous lymphoproliferative disorders other than mycosis fungoides/sezary syndrome
	Chairs: I. Oschlies, J. Goodlad
11.00–11.05	Introduction
11.05–12.40	Case presentations
	EAHP18-LYWS-350 Primary cutaneous anaplastic large cell lymphoma with angiocentric and angiodestructive growth: an unusual and rare variant <i>W. Kempf</i>
	EAHP18-LYWS-519 A case of Lymphomatoid Papulosis with lymph node involvement and Clonally Related Mycosis Fungoides <i>K. Hüttl</i>
	EAHP18-LYWS-277 A case of a Recurrent Primary Cutaneous CD30+ Lymphoproliferative Disorder with DUSP22 rearrangement <i>M.-L. Jullie</i>
	EAHP18-LYWS-142 Atypical CD4+ lymphocytic proliferation in the skin: T-cell pseudolymphoma, cutaneous CD4+ small/medium-sized lymphoproliferative disorder or cutaneous peripheral T-cell lymphoma, NOS <i>C. Dommann-Scherrer</i>
	EAHP18-LYWS-179 Primary cutaneous CD8+ aggressive epidermotropic cytotoxic T-cell lymphoma <i>P. W. Raess</i>
	EAHP18-LYWS-563 Indolent Epidermotropic Gamma Delta T-cell Lymphoma <i>R. Pillai</i>
	EAHP18-LYWS-355 Primary Cutaneous Acral CD8 positive T-cell lymphoma involving the lower leg <i>A. Dogan</i>
	EAHP18-LYWS-232 Primary cutaneous follicle center lymphoma (WHO 2016) composed of predominantly large cells <i>J. Dalland</i>
12.40–13.00	Summary
13.00–14.00	Lunch Break

Pentland Auditorium	LYMPHOMA WORKSHOP SESSION 2
14.00–16.00	Lymphoproliferative disorders in immune privileged sites
	Chairs: R. King, J. Ferry
14.00–14.05	Introduction
14.05–15.40	Case presentations
	EAHP18-LYWS-100 Clonal Evolution in a case of Central Nervous System Large B-cell lymphoma with testicular relapse <i>S. Montes-Moreno</i>
	EAHP18-LYWS-376 Diffuse large B-cell lymphoma of the testis and central nervous system <i>N. Lewis</i>
	EAHP18-LYWS-550 A rare combination of diseases in the brain, how to treat? <i>M. Kocken</i>
	EAHP18-LYWS-156 Seroma-confined breast implant-associated anaplastic large cell lymphoma <i>M. Rahilly</i>
	EAHP18-LYWS-572 Gastric silicon band associated ALK-negative anaplastic large cell lymphoma <i>T. C. Greiner</i>
	EAHP18-LYWS-353 Diffuse Large B-cell Lymphoma, Non-Germinal Center-Like, Double-Expresser Type, Arising in a Sporadic Atrial Myxoma, Showing a Central Nervous System Diffuse Large B-cell Lymphoma-Like Mutational Pattern (Pathogenic Mutations in PIM1 and ETV6 Genes) <i>J. S. Sidhu</i>
	EAHP18-LYWS-403 Non-anaplastic breast implant EBV+lymphoma associated with chronic inflammation <i>L. Mescam</i>
	EAHP18-LYWS-332 HHV8 and EBV-negative effusion-based diffuse large B-cell lymphoma in an 88-year old female <i>E. S. Jaffe</i>
15.40–16.00	Summary
16.00–16.30	Coffee Break

Pentland Auditorium	LYMPHOMA WORKSHOP SESSION 3
16.30–17.50	Gastrointestinal lymphoproliferative disorders (T-cell)
	Chairs: M. Calaminici, S. Montes-Moreno
16.30–16.35	Introduction
16.35–17.35	Case presentations
	EAHP18-LYWS-421 Indolent CD4+ T-cell lymphoproliferative disorder of the small bowel <i>G. Madrid-Valero</i>
	EAHP18-LYWS-252 Novel somatic JAK3 and AXL mutations in NK-cell enteropathy: genetic evidence of a neoplastic process <i>W. Xiao</i>
	EAHP18-LYWS-276 Evolving enteropathy-associated T-cell lymphoma <i>B. Basha</i>
	EAHP18-LYWS-281 Enteropathy-associated T-cell lymphoma with DUSP22/IRF4 gene rearrangement presenting as large jejunal mass <i>W. Macon</i>
	EAHP18-LYWS-311 Monomorphic epithelial intestinal T-cell lymphoma beyond the intestines <i>L. de Leval</i>
17.35–17.50	Summary

Pentland Auditorium	LYMPHOMA WORKSHOP SESSION 4
8.30–9.50	Gastrointestinal lymphoproliferative disorders (B-cell)
	Chairs: M. Calaminici, S. Montes-Moreno
8.30–8.33	Introduction
8.33–9.35	Case presentations
	EAHP18-LYWS-199 Duodenal-type follicular lymphoma with extensive involvement of small intestine and regional lymph nodes <i>M. M. Bühler</i>
	EAHP18-LYWS-433 Duodenal-type follicular lymphoma BCL2 “pseudo-negative” due to BCL2 mutation <i>L. Quintanilla-Fend</i>
	EAHP18-LYWS-378 Duodenal follicular lymphoma: Clinical course spanning three decades <i>E. Hsi</i>
	EAHP18-LYWS-204 Large B-cell lymphoma with IRF4 rearrangement <i>E. McPhail</i>
	EAHP18-LYWS-329 Cyclin D1-negative mantle cell lymphoma: an evasive presentation of a rare entity <i>S. Sadigh</i>
9.35–9.50	Summary
Pentland Auditorium	LYMPHOMA WORKSHOP SESSION 5
9.50–10.30	Challenging extranodal lymphoproliferative disorders
	Chairs: S. Dotlic, G. Ott
9.50–9.55	Introduction
9.55–10.30	Case presentations
	EAHP18-LYWS-356 Primary thyroid nodular lymphocyte predominant Hodgkin lymphoma <i>T. P. Williams</i>
	EAHP18-LYWS-240 ATM- and NOTCH2-mutated, CD5- and SOX11-negative blastoid mantle cell lymphoma <i>M. M. Gerlach</i>
	EAHP18-LYWS-324 Rectal tonsil: recognition of a rare reactive process (and lymphoma mimic) <i>S. Sadigh</i>

10.30–11.00	Coffee Break
Pentland Auditorium	LYMPHOMA WORKSHOP SESSION 5
11.00–12.30	Challenging extranodal lymphoproliferative disorders
	Chairs: S. Dotlic, G. Ott
11.00–12.10	Case presentations
	EAHP18-LYWS-562 Composite Extranodal Marginal Zone lymphoma of MALT-type and early phase Mantle cell lymphoma of the lung <i>C. Copie Bergmann</i>
	EAHP18-LYWS-190 IgG4-related, monotypic and monoclonal, plasma cell proliferation of the orbit <i>L. Lorenzi</i>
	EAHP18-LYWS-473 Transient blood transfusion reaction masquerading as a post-transplantation lymphoproliferative disorder mimicking acute leukemia cutis <i>A. Davis</i>
	EAHP18-LYWS-285 Atypical lymphoid proliferations in the skull base and skeleton of a young woman, with associated indolent immature T lymphoid proliferations and myasthenia gravis <i>L. Soma</i>
	EAHP18-LYWS-382 PICALM-MLL10 fusion linking immunophenotypically divergent acute leukemia involving bilateral skin lesions without marrow involvement <i>K. Petrova-Drus</i>
	EAHP18-LYWS-504 Primary omental gamma-delta T-cell lymphoma associated with a clonal hypereosinophilic disorder and harboring pathogenic mutations in FAS and SH2B3 Genes <i>S. Brar</i>
12.10–12.30	Summary
12.30–13.30	Lunch Break

Pentland Auditorium LYMPHOMA WORKSHOP SESSION 6

13.30–15.30 Extranodal lymphoproliferative disorders, not site specific

Chairs: A. Traverse-Glehen, M. Ponzoni

13.30–13.35

Introduction

13.35–15.10

Case presentations

EAHP18-LYWS-500

Intravascular Large B-cell Lymphoma localized to skin
R. Jackson

EAHP18-LYWS-175

Indolent "prodromal" phase of extranodal NK/T-cell lymphoma, nasal type with subsequent skin involvement
S. E. Gibson

EAHP18-LYWS-487

Plasma cell neoplasm of the testis revealing multiple myeloma
D. Milowich

EAHP18-LYWS-323

An unusual cutaneous presentation of extracavitary primary effusion lymphoma
S. Song

EAHP18-LYWS-137

KSHV/HHV8-associated extracavitary primary effusion lymphoma presenting as Multiple lymphomatous polyposis
Q. Huang

EAHP18-LYWS-386

Hairy cell leukemia presenting as a dural-based mass mimicking meningioma
M. Vergara-Lluri

EAHP18-LYWS-148

T-PLL infiltrating the heart
S. Dirnhofer

EAHP18-LYWS-316

Gastric involvement by adult T-cell leukemia/lymphoma in a patient from a non-endemic HTLV1 area
T. Hu

15.10–15.30

Summary

Pentland Auditorium

15.30–15.35 Closing Ceremony

Posters will be exhibited in the Poster Exhibition Area on Level -2. They are aimed to give a crisp overview on current research activities and to initiate discussions. All conference participants are invited to join. During the Lymphoma Symposium, a small series of selected posters will be orally presented in the Exhibition Area during the morning coffee breaks on Monday, 1 October and Tuesday, 2 October.

Poster Viewing

Sunday, 30 September 2018 10.10–11.00, 13.00–14.00 and 16.00–16.30

Monday, 1 October 2018 15.30–16.00

The official Lymphoma Poster Presentation

Monday, 1 October 2018 10.15–11.00

Tuesday, 2 October 2018 10.15–11.00

BMWS-P-1

Mixed-phenotype acute leukemia (B-/myeloid) with BCR-ABL1 like alterationJohn KSS Philip¹, Sandeep Gurbuxani¹, Andrew Artz², Jeremy Segal¹, Michelle Le Beau², Madina Sukhanova², Y. Lynn Wang², Elizabeth Hyjek¹, Girish Venkataraman¹¹Pathology, ²Medicine, University of Chicago, Chicago, United States

BMWS-P-2

Blastic Plasmacytoid Dendritic Cell Neoplasm: genomics mark epigenetic dysregulation as a primary therapeutic targetMaria Rosaria Sapienza¹¹Department of Experimental, Diagnostic, and Specialty Medicine, University of Bologna, Bologna, Italy

BMWS-P-3

Impact of Clinicopathologic Factors on Overall Survival in Bone Marrow Involvement by Diffuse Large B Cell Lymphoma: Indian ScenarioPooja K. Gajaria¹, Tanuja Shet¹, Epari Sridhar¹, Manju Sengar²¹Pathology, ²Medical Oncology, Tata Memorial Hospital, Mumbai, India, Mumbai, India

BMWS-P-4

Primary bone marrow large B cell lymphoma is more often associated with hemophagocytic syndrome, cytogenetic abnormalities and less 1-year-survival rate than the diffuse large B cell lymphoma with secondary marrow involvementChing-Fen Yang¹, Chih-Yi Hsu¹¹Pathology and Laboratory Medicine, Taipei Veterans General Hospital, Taipei, Taiwan

BMWS-P-5

CD56 expression in myeloid neoplasias with excess of blasts is accompanied by significant numeric underestimation of blasts on bone marrow aspirates compared to bone marrow biopsiesAlexandar Tzankov¹, Beatrice Drexler², Maria Martinez², Severin Baerlocher², Jakob R. Passweg², Stephan Dirnhofer², Dimitrios Tsakiris², Jan C. Dirks²¹Pathology, ²Hematology, University Hospital Basel, Basel, Switzerland

BMWS-P-6

Primary Bone Marrow Burkitt LeukemiaShiraz Fidai¹, Madina Sukhanova², Wendy Stock², Girish Venkataraman¹¹Pathology, ²Medicine, The University of Chicago Medicine, Chicago, United States

Poster Presentations

Bone Marrow

BMWS-P-7

Hodgkin lymphoma with marrow involvement as presenting featureTanuja Shet¹, Sridhar Epari¹, Manju Sengar², Hashmukh Jain² and Hematolymphoid disease management group¹Dept of Pathology, ²Medical Oncology, Tata Memorial Hospital, Mumbai, India

BMWS-P-8

Clinical and Laboratory Characteristics of IgA Plasma Cell NeoplasmsGabriel Habermehl¹, Megan Nakashima¹, Claudiu Cotta¹¹Laboratory Medicine, Cleveland Clinic, Cleveland, United States

BMWS-P-9

Bone Marrow Involvement by different LymphomasXiaohong Zhang¹¹Pathology, Geisinger Health System, Wilkes-Barre, United States

BMWS-P-10

Bone marrow presentation of T-cell lymphoma in two patients with chronic lymphocytic leukemiaDina Milowich¹, Mounir Trimech¹, Anne Cairoli², Nicolas Ketterer³, Bettina Bisig¹, Laurence de Leval¹¹Institute of Pathology, ²Department of Hematology, Lausanne University Hospital, ³Center of Oncology, Clinique Bois-Cerf, Lausanne, Switzerland

BMWS-P-11

Finding the incidence of Mucormycosis in Hodgkin Lymphoma patients with undergoing Bone Marrow TransplantationArooj Fatima¹, Syed Sammar Abbas Zaidi^{1,2}¹SKMC & RC, ²wecare medical centre, Lahore, Pakistan

BMWS-P-12

The bone marrow involvement in classic Hodgkin lymphoma – a five-year study in a single instituteHsin-Ni Li¹, Ren Ching Wang¹¹Department of Pathology and Laboratory Medicine, Taichung Veterans General Hospital, Taichung City, Taiwan

BMWS-P-13

Differences in the Hodgkin lymphoma microenvironment between lymph node and bone marrowTriantafyllia Koletsis¹, Sofia-Eleni Tzorakoleftheraki¹, Maria Papaioannou², Georgia Karayannopoulou¹, Ioannis Kostopoulos¹¹Pathology Department, Aristotle University of Thessaloniki, ²Haematology Department, First Department of Internal Medicine, AHEPA University Hospital, Aristotle University of Thessaloniki, Thessaloniki, Greece

BMWS-P-14

Lymphoplasmocytic lymphoma and polycythemia vera: a case of rare co-occurrence, both contributing to clinical hyperviscosity syndromeTihomir Dikov¹, Nikolay Stoyanov¹, Gueorgui Balatzenko², Branimir Spassov³, Margarita Guenova¹¹Laboratory of Hematopathology and Immunology, ²Laboratory of Cytogenetics and Molecular Biology, ³Hematology Clinic, National specialised Hospital for active treatment of hematological Diseases, Sofia, Bulgaria

BMWS-P-15

Bone marrow biopsy as the only specimen for diagnosis of transformation of splenic marginal zone lymphoma to Burkitt lymphomaTatjana Terzic¹, Milica Radojkovic², Sanja Cirovic¹, Bojana Cikota Aleksic³, Slobodan Ristic²¹Institute of Pathology, Faculty of Medicine, University of Belgrade, ²Clinic of Internal Medicine, CHC "Dr Dragisa Misovic-Dedinje", Belgrade, Serbia, ³Department for Molecular Genetics, Military Medical Academy, Belgrade, Serbia, Belgrade, Serbia

Poster Presentations

Bone Marrow

BMWS-P-16

Bone marrow presentation of T-cell/ histiocyte-rich large B-cell lymphomaJonathan Ben-Ezra^{1,2}, Ohad Bentur³¹Department of Pathology, Tel Aviv Sourasky Medical Center, ²Department of Pathology, Sackler School of Medicine of Tel Aviv University, ³Department of Hematology, Tel Aviv Sourasky Medical Center, Tel Aviv, Israel

BMWS-P-17

A challenging case of Hodgkin lymphoma with primary presentation as bone marrow infiltratesPragya Katoch¹, Preben Johansen¹¹Pathology, Aalborg Universitetshospital, Aalborg Universitetshospital, Aalborg, Denmark

BMWS-P-18

Monoclonal plasmacytosis in bone marrow biopsy as a initial presentation of acute myeloid leukaemiaMirjana Prvanovic¹, Natasa Stanisavljevic², Olivera Markovic², Tatjana Terzic¹¹Institute of Pathology, Faculty of Medicine, University of Belgrade, ²University Hospital Clinical Centre Bezanjska Kosa, Belgrade, Serbia, Belgrade, Serbia

BMWS-P-19

Diffuse large B-cell lymphoma with primary involvement of the bone marrow presenting with cold agglutinin disease. A case reportGeorge Kanellis¹, Ekaterini Xirokosta², Leonidas Marinos¹, Despoina Barbarousi², Asimina Papanikolaou¹¹Hematopathology Dpt, Evangelismos Hospital, ²Hematology Dpt, Alexandras Hospital, Athens, Greece

BMWS-P-20

Ki-67 in primary myelofibrosis: proliferative activity of megakaryocytesDmitrii A. Diakonov¹, Nadezhda Fedorovskaya¹, Elena Fokina²¹Laboratory of Pathomorphology, ²Hematology, Federal State Budgetary Institution of Science "Kirov Research Institute of Hematology and Blood Transfusion of Federal Medical and Biologic Agency", Kirov, Russian Federation

BMWS-P-21

Necrotizing lymphadenopathy with prominent Azzopradi effect in autoimmune disorder possible systemic lupus erythematosus fulminantRuijun J. Su¹, Mingyi Chen²¹University of California at Davis, Sacramento, ²UT Southwestern Medical Center, Dallas, United States

Poster Presentations

Lymphoma

LYS-P-2

Epstein-Barr virus leaves its mark: New evidence for “hit and run” hypothesis from non-conventional methods

Lucia Mundo¹, Maria R. Ambrosio¹, Leonardo Del Porro¹, Gianluca Schiavoni², Giuseppe Lo Bello¹, Massimo Granai¹, Stefano Lazzi¹, Raffaella Santi³, Federica Vergoni³, Enrico Tiacci², Lorenzo Leoncini^{1, 1}

¹University of Siena, Siena, ²University of Perugia, Perugia, ³University of Florence, Florence, Italy

LYS-P-3

Screening for prognostic molecular signatures in symptomatic follicular lymphoma patients treated without chemotherapy

Ellen Leich-Zbat¹, Tobias Schmidt², Michael Altenbuchinger², Marianne Brodtkorb³, Sandra Lockmer⁴, Harald Holte³, Chloe Beate Steen⁵, Theodora Nedeva¹, Tina Grieb¹, Jordan Pischmarov¹, Birgitta Sander⁶, Crister Sundström⁷, Rainer Spang², Eva Kimby⁸, Andreas Rosenwald¹ and Nordic Lymphoma Study Group

¹Institute of Pathology, University of Würzburg, Würzburg, ²Institute of Functional Genomics, University of Regensburg, Regensburg, Germany, ³Department of Oncology, Oslo University Hospital, Oslo, Norway, ⁴Department of Medicine at Huddinge, Karolinska Institute, Stockholm, Sweden, ⁵Department of Informatics, Oslo University Hospital, Oslo, Norway, ⁶Department of Laboratory Medicine, Division of Pathology, Karolinska Institute, Stockholm, ⁷Department of Genetics and Pathology, Rudbeck Laboratory, Uppsala University Hospital, Uppsala, ⁸Division of Hematology, Dept. of Medicine at Huddinge, Karolinska Institutet, Stockholm, Sweden

LYS-P-4

Validation of the MCL35 gene expression proliferation assay in randomized trials of the European Mantle Cell Lymphoma Network

Hilka Rauert-Wunderlich^{1, 2}, Anja Mottok³, David W. Scott⁴, Lisa M. Rimza⁵, German Ott⁶, Wolfram Klapper⁷, Michael Unterhalt⁸, Hanneke C. Kluijn-Nelemans⁹, Olivier Hermine^{10, 11}, Sylvia Hartmann¹², Christoph Thorns¹³, Grzegorz Rymkiewicz¹⁴, Harald Holte¹⁵, Martin Dreyling⁸, Eva Hoster^{8, 16}, Andreas Rosenwald^{1, 2}

¹Comprehensive Cancer Center (CCC), Mainfranken, ²Institute of Pathology, University of Würzburg, Würzburg, ³University Hospital of Ulm, Ulm, Germany, ⁴British Columbia Cancer Agency, Vancouver, Canada, ⁵Mayo Clinic, Scottsdale, United States, ⁶Robert-Bosch Krankenhaus, Stuttgart, ⁷Hematopathology Section and Lymph Node Registry, University of Kiel, Kiel, ⁸University Hospital of the Ludwig Maximilians University Munich, Munich, Germany, ⁹University Medical Center Groningen, University of Groningen, Groningen, Netherlands, ¹⁰Imagine Institute, University of Sorbonne Paris City, ¹¹Department of Hematology, University Paris Descartes, Paris, France, ¹²Dr. Senckenberg Institute of Pathology, Goethe University, Frankfurt am Main, ¹³Institute of Pathology, Marienkrankenhaus, Hamburg, Germany, ¹⁴Department of Pathology and Laboratory Diagnostics, Maria Skłodowska-Curie Institute-Oncology Center, Warsaw, Poland, ¹⁵Department of Oncology, Oslo University Hospital, Oslo, Norway, ¹⁶Institute for Medical Information Processing, Biometry and Epidemiology, Ludwig Maximilians University Munich, Munich, Germany

Poster Presentations

Lymphoma

LYS-P-5

MYC translocation positive diffuse large B-cell lymphoma has a distinct mutational spectrum

Francesco Cucco¹, Sharon Barrans², Alexandra Clipson¹, Joe Sneath Thompson¹, Rachel Dobson¹, Hannah Kennedy¹, Ming Wang¹, Daniel Painter³, Alexandra Smith³, Chulin Sha⁴, Josh Caddy⁵, Thomas Cummin⁶, Eve Roman³, David R Westhead⁴, Cathy Burton², Andrew J Davies⁶, Peter Johnson⁶, Ming-Qing Du^{1, 7}

¹Department of Pathology, University of Cambridge, Cambridge, ²HMDs, Leeds Cancer Centre, Leeds Teaching Hospitals NHS Trust, Leeds, ³ECsG, Department of Health Sciences, Seebohm Rowntree Building, University of York, Heslington, York, ⁴School of Molecular and Cellular Biology, University of Leeds, Leeds, ⁵Southampton Clinical Trials Unit, ⁶Cancer Research UK Clinical Centre, University of Southampton, Southampton, ⁷Department of Histopathology, Addenbrooke's Hospital, Cambridge University Hospitals NHS Foundation Trust, Cambridge, United Kingdom

LYS-P-6

MYC-related micrnas signatures in non-Hodgkin B-cell lymphomas and their relationships with core cellular pathways

Giorgio Malpeli¹, Stefano Barbi¹, Gabriele Tosadori², Corinna Greco³, Mauro Kramer³, Paul Takam Kamga³, George A. Calin⁴, Carlo M. Croce⁵, Alberto Zamò⁶, Aldo Scarpa⁷

¹Diagnostics and Public Health, ²Center for Biomedical Computing, ³Department of Medicine, University of Verona, Verona, Italy, ⁴Department of Experimental Therapeutics, The University of Texas MD Anderson Cancer Center, Houston, TX, ⁵Department of Molecular Virology, The Ohio State University, Columbus, OH, United States, ⁶Department of Oncology, University of Turin, Turin, ⁷Department of Diagnostics and Public Health, University of Verona, Verona, Italy

LYS-P-7

CDKN2A alteration in PTCL with a TFH phenotype: a recurrent event that could confer a sensitivity to MDM2 inhibitors

Clemence Loiseau¹, George Allen², Loeticia Favre¹, Laura Pelletier³, Aurélie Dupuy³, Nadine Martin³, Anais Pujals⁴, Virginie Fataccioli⁵, Nicolas Ortonne³, Pamela Dobay², Laurence de Leval², Francois Lemonnier⁶, Philippe Gaulard⁵

¹U955, IMRB, Creteil, France, ²departement de pathologie, CHUV, Lausanne, Switzerland, ³U955, IMRB, Créteil, ⁴departement de pathologie, Henri Mondor hospital, Créteil, ⁵departement de pathologie, ⁶Unité Hémopathies Lymphoïdes, Henri Mondor hospital, Créteil, France

LYS-P-8

Histiocytic neoplasms with myeloid neoplasm-associated genetic alterations suggest hematopoietic stem cells as a cell of origin

Mariko Yabe¹, Kseniya Petrova-Drus¹, Benjamin H. Durham², Omar Abdel-Wahab², Raajit K. Rampal³, Eli L. Diamond⁴, Ahmet Dogan¹

¹Hematopathology, ²Human Oncology and Pathogenesis Program, ³Leukemia Service, ⁴Department of Neurology, Memorial Sloan Kettering Cancer Center, New York, United States

LYS-P-9

TP53 mutations are enriched in Mantle cell lymphoma with negative and low SOX11 expression demonstrated by in situ hybridization assay for quantification of SOX11 mRNA expression

Birgit Federmann¹, Helga Pertsch¹, Julia Steinhilber¹, Irina Bonzheim¹, Leonie Frauenfeld¹, Falko Fend¹, Leticia Quintanilla-Martinez¹

¹Institute of Pathology and Neuropathology, CCC and University Hospital Tuebingen, Tuebingen, Germany

Poster Presentations

Lymphoma

LYS-P-10

Post-transcriptional modifications of small RNAs as prediction signatures for response to R-CHOP treatment in Diffuse Large B-cell Lymphoma

C. Scheepbouwer^{1,2}, S. Giannoukakos¹, E. Aparicio³, H. Verschueren¹, B. Misovic¹, J. Boele¹, J.M. Zijlstra-Baalbergen⁴, R.E. Kibbelaar⁵, M. Hackenberg³, D. de Jong², D. Koppers-Lalic^{1,2}
¹Neurosurgery, ²Pathology, VU Medical Center, Amsterdam, Netherlands, ³Genetics, University of Granada, Granada, Spain, ⁴Hematology, VU Medical Center, Amsterdam, ⁵Pathology, Stichting HemoBase, Leeuwarden, Netherlands

LYS-P-11

MHC class II transactivator (CIITA) abnormalities are frequent in B-cell lineage lymphomas and are associated with loss of MHC Class II (MHCII) expression

Fatima Zahra Jelloul¹, Janine Pichardo¹, Achim Jungbluth¹, Lu Wang¹, Connie Batlevi¹, Maria Arcila¹, Yanming Zhang¹, Ahmet Dogan¹
¹Pathology, Memorial Sloan Kettering Cancer Center, New York, United States

LYS-P-12

In situ follicular neoplasia lacks activation-induced cytidine deaminase

Tanu Goyal¹, Sarah Ondrejka¹, Lisa Durkin¹, Juraj Bodo¹, Eric D. Hsi¹
¹Laboratory Medicine, Cleveland Clinic, Cleveland, United States

LYS-P-13

Mutation screening using formalin-fixed paraffin-embedded tissues: a stratified approach according to DNA quality

Francesco Cucco¹, Alexandra Clipson¹, Hannah Kennedy¹, Joe Sneath Thompson¹, Ming Wang¹, Sharon Barrans², Moniek van Hoppe², Eguzkine Ochoa Ruiz¹, Josh Caddy³, Debbie Hamid³, Thomas Cummin⁴, Cathy Burton⁵, Andrew J Davies⁴, Peter Johnson⁴, Ming-Qing Du^{1,6}
¹Department of Pathology, University of Cambridge, Cambridge, ²HMDS, Leeds Cancer Centre, Leeds Teaching Hospitals NHS Trust, Leeds, ³Southampton Clinical Trials Unit, ⁴Cancer Research UK Clinical Centre, University of Southampton, Southampton, ⁵HMDS, Leeds Teaching Hospitals NHS Trust, Leeds, ⁶Department of Histopathology, Cambridge University Hospitals NHS Foundation Trust, Cambridge, United Kingdom

LYS-P-14

The immune landscape of Burkitt lymphoma: dysfunctional T-cells phenotype and M2-macrophages polarization

Giuseppe Lo Bello¹, Ayse Akarca², Maria Raffaella Ambrosio¹, Lucia Mundo¹, Massimo Granai¹, Noel Onyango³, Isaac Ndede⁴, Elena Sabattini⁵, Michele Bibas⁶, Stefano Lazzi⁷, Lorenzo Leoncini⁷, Teresa Marafioti²
¹Medical Biotechnologies, University of Siena, Siena, Italy, ²Department of Histopathology, University College London, London, United Kingdom, ³Department of Clinical Medicine and Therapeutics, University of Nairobi, Nairobi, ⁴Department of Immunology, Moi University School of Medicine, Eldoret, Kenya, ⁵Department of Haematology and Clinical Oncology, Haematopathology University Hospital Bologna, Bologna, ⁶National Infectious Diseases Lazzaro Spallanzani, Lazzaro Spallanzani, Roma, ⁷Medical Biotechnology, University of Siena, Siena, Italy

Poster Presentations

Lymphoma

LYS-P-15

RNA-SEQ studies in primary intestinal T-cell lymphomas

Rebeca Manso¹, Marta Rodriguez-Moreno¹, Maria Rodriguez-Remirez², Javier Menarguez³, Cristina Chamizo¹, Raul Cordoba⁴, Federico Rojo¹, Miguel Angel Piris Pinilla¹, Socorro Maria Rodriguez-Pinilla¹
¹Pathology, ²Oncology, FJD, ³Pathology, Hospital Gregorio Marañon, ⁴Haematology, FJD, Madrid, Spain

LYS-P-16

Epstein Barr virus positive mucocutaneous ulcer and classical Hodgkin Lymphoma share similar immune microenvironmental features

Matthew R. Pugh¹, Ayse Akarca², Louise King³, Teresa Marafioti², Stefan Dojcinov¹
¹Department of Cellular Pathology, All Wales Lymphoma Panel, University Hospital of Wales, Cardiff, ²Department of Pathology, University College London, London, ³Cellular Pathology, University Hospital of Wales, Cardiff, United Kingdom

LYS-P-17

Combined effects of MYC and EBV on lipid metabolism in aggressive B-cell lymphomas

Maria R. Ambrosio¹, Mohsen Navari², Stefano Lazzi¹, Lucia Mundo¹, Giuseppe Lo Bello¹, Virginia Mancini¹, Cristiano Peron³, Thomas Menter⁴, Alexander Tzankov⁴, Stephen Dirnhofer⁴, Lorenzo Leoncini¹, Pier P. Piccaluga³
¹University of Siena, Siena, Italy, ²Torbat Heydariyeh University of Medical Sciences, Torbat Heydariyeh, Iran, Islamic Republic Of, ³Bologna University School of Medicine, Bologna, Italy, ⁴University of Basel, Basel, Switzerland

LYS-P-18

Prognostic impact of MYC, BCL2 and/or BCL6 rearrangements status in large B cell lymphoma

Jiyeon Hyeon¹, Hye Won Hwang², Dohee Kwon², Seung-Myoung Son³, Inju Cho⁴, Ji Yun Jeong⁵, Seok-Jin Kim⁶, Won Seog Kim⁶, Young-Hyeh Ko²
¹Department of Pathology, Incheon St Mary's hospital, College of Medicine, The Catholic University of Korea, Incheon, ²Department of Pathology and Translational Genomics, Samsung Medical Center, Sungkyunkwan University School of Medicine, Seoul, ³Departments of Pathology, Chungbuk National University Hospital, Cheongju, ⁴Department of Hospital Pathology, Yeouido St. Mary's Hospital, The Catholic University of Korea, Seoul, ⁵Department of Pathology, Kyungpook National University Chilgok Hospital, Kyungpook National University, Daegu, ⁶Division of hematology-oncology, Department of Internal medicine, Samsung Medical Center, Sungkyunkwan University School of Medicine, Seoul, Korea, Republic Of

LYS-P-19

Targeted deep sequencing of gastric marginal zone lymphoma identified alterations of TRAF3 and TNFAIP3 that were mutually exclusive for MALT1 rearrangement

Jiyeon Hyeon¹, Boram Lee², So-Hyun Shin³, Hae Yong Yoo⁴, Seok Jin Kim⁵, Won Seog Kim⁵, Young-Hyeh Ko³, Woong-Yang Park²
¹Department of Pathology, Incheon St Mary's hospital, College of Medicine, The Catholic University of Korea, Incheon, ²Samsung Genome Institute, Research Institute for Future Medicine, Samsung Medical Center, ³Department of Pathology and Translational Genomics, Samsung Medical Center, Sungkyunkwan University School of Medicine, ⁴Department of Health Sciences and Technology, Samsung Advanced Institute for Health Sciences and Technology, Sungkyunkwan University, ⁵Division of hematology-oncology, Department of Internal medicine, Samsung Medical Center, Sungkyunkwan University School of Medicine, Seoul, Korea, Republic Of

Poster Presentations

Lymphoma

LYS-P-20

DNA methylation analysis on paraffin embedded tissue as a new tool for the differential diagnosis between T-Lymphoblastic Lymphoma (T-LBL) and lymphocyte-rich thymoma

Aurore Touzart^{1,2}, Mohamed Belhocine³, Salvatore Spicuglia³, Vincent Thomas de Montpreville⁴, Lara Chalabreysse⁵, Alexander Marx⁶, Nicolas Girard⁷, Laure Gibault⁸, Benjamin Besse⁹, Elizabeth Macintyre^{1,2}, Vahid Asnafi^{1,2}, Thierry Jo Molina¹⁰

¹Laboratory of Onco-Haematology, Hôpital Necker Enfants-Malades, ²Institut Necker-Enfants Malades (INEM), Paris, ³TAGC, Marseille, ⁴Department of Pathology, Institut d'oncologie thoracique, Hôpital Marie-Lannelongue, Le Plessis-Robinson, ⁵Department of Pathology, Hôpital Louis-Pradel, Hospices Civils de Lyon, Lyon, France, ⁶Institute of Pathology, Mannheim Medical University, Heidelberg University, Mannheim, Germany, ⁷Université de Lyon, Hospices Civils de Lyon, Lyon, ⁸department of pathology, hopital HEGP, Paris, ⁹Department of Cancer Medicine, institut Gustave Roussy, Villejuif, ¹⁰department of pathology, hopital Necker-Enfants Malades, Paris, France

LYS-P-21

Clinico-pathological and molecular heterogeneity of breast-implant lymphomas

Léna Mescam¹, José Adelaide², Anne Murati¹, Marie Bannier³, Séverine Garnier², Arnaud Guille², Jean Marc Schiano⁴, Max Chaffanet², Daniel Birnbaum², Luc Xerri¹

¹Biopathology, ²Molecular oncology, ³Surgery, ⁴Hematology, Institut Paoli Calmettes, Marseille, France

LYS-P-22

Integrated analysis of signal transducers and activators of transcription 3 (STAT3) associated factors in diffuse large B-cell lymphoma

Kazuho Morichika¹, Kennosuke Karube², Risa Watanabe³, Mamoru Kawaki³, Sakiko Kitamura¹, Sachie Uchibori¹, Shohei Tomori¹, Taeko Hanashiro¹, Natsuki Shimabukuro¹, Iori Tedokon¹, Keita Tamaki¹, Yukiko Nishi¹, Sawako Nakachi¹, Satoko Morishima¹, Junnosuke Uchihara⁴, Takeaki Tomoyose⁵, Kazuiku Ohshiro⁵, Iwao Nakazato⁶, Atsushi Yamanoha⁷, Takashi Miyagi⁷, Tetsuro Nakazato⁸, Masaki Hayashi⁹, Taishi Takahara¹⁰, Akira Satou¹⁰, Satoko Shimada¹¹, Kazuyuki Shimada¹², Toyonori Tsuzuki¹⁰, Shigeo Nakamura¹¹, Takuya Fukushima¹³, Hiroaki Masuzaki¹

¹Division of Endocrinology, Diabetes and Metabolism, Haematology, Rheumatology (Second Department of Internal Medicine), ²Department of Cell Biology and Pathology, Graduate School of Medicine, University of the Ryukyus, ³Medical Student, Faculty of Medicine, University of the Ryukyus, ⁴Department of Haematology, Naha-City Hospital, ⁵Department of Haematology, ⁶Department of Pathology, Okinawa Prefectural Nanbu Medical Center and Children's Medical Center, ⁷Department of Haematology, Heartlife Hospital, ⁸Department of Haematology, Okinawa Red Cross Hospital, ⁹Department of Haematology, Nakagami Hospital, Okinawa, ¹⁰Department of Surgical Pathology, Aichi Medical University Hospital, ¹¹Department of Pathology and Clinical Laboratories, ¹²Department of Haematology and Oncology, Nagoya University Graduate School of Medicine, Aichi, ¹³Laboratory of Haematology, School of Health Sciences, Faculty of Medicine, University of the Ryukyus, Okinawa, Japan

Poster Presentations

Lymphoma

LYS-P-23

Activated signal transducers and activators of transcription (STAT3) in adult T cell leukemia/lymphoma and its association with disease subtypes and clinical findings

Kazuho Morichika¹, Kennosuke Karube², Hirone Kayo³, Shuta Uchino³, Satoko Morishima¹, Sawako Nakachi¹, Kazuiku Ohshiro⁴, Iwao Nakazato⁵, Takuya Fukushima⁶, Hiroaki Masuzaki¹

¹Division of Endocrinology, Diabetes and Metabolism, Haematology, Rheumatology (Second Department of Internal Medicine), ²Department of Cell Biology and Pathology, Graduate School of Medicine, University of the Ryukyus, ³Medical Student, Faculty of Medicine, University of the Ryukyus, ⁴Department of Haematology, Okinawa Prefectural Nanbu Medical Center and Children's Medical Center, ⁵Department of Pathology, Okinawa Prefectural Nambu Medical Center and Children's Medical Center, ⁶Laboratory of Haematology, School of Health Sciences, Faculty of Medicine, University of the Ryukyus, Okinawa, Japan

LYS-P-24

Engineered bioluminescent 3D lymphoma avatars for targeted therapy

Maura Rossi¹, Elisa Michelini², Barbara Roda^{2,3}, Francesco Alviano¹, Martina Rossi¹, Maria Maddalena Calabretta², Silvia Zia³, Iliaria Vigiotta³, Simona Righi¹, Salvatore Collura¹, Francesca Scellato¹, Maria Antonella Laginestra⁴, Maria Rosaria Sapienza¹, Laura Bonsi¹, Aldo Roda², Claudio Agostinelli¹, Elena Sabattini⁴

¹Department of Experimental, Diagnostic and Specialty Medicine, ²Department of Chemistry "Giacomo Ciamician", University of Bologna, ³Stem Sel srl, Bologna, ⁴Unit of Haematopathology, Sant'Orsola Hospital, Bologna, Italy

LYS-P-25

Transformation of follicular lymphoma to Epstein Barr virus positive diffuse large B-cell lymphoma: A case report and review of the literature

Massimo Granai¹, Lucia Mundo¹, Ayse Akarca², Giuseppe Lo Bello¹, Virginia Mancini¹, Federica Vergoni³, Raffaella Santi⁴, Gioia Di Stefano³, Teresa Marafioti², Lorenzo Leoncini^{1,1}, Maria R. Ambrosio¹, Stefano Lazzi¹

¹University of Siena, Siena, Italy, ²University College London, London, United Kingdom, ³University of Florence, Florence, ⁴University of Florence, Siena, Italy

LYS-P-26

Comprehensive analysis of Follicular Lymphoma evolution based on immunoglobulin variable region gene sequences reveal acquisition of N-glycosylation motifs is an early and stable event in pathology

Mariette Odabashian¹, Emanuela Carlotti², Shamzah Araf¹, Jessica Okosun¹, Francesco Forconi³, Freda Stevenson³, Sergey Krysov¹, Mariarita Calaminici¹, John Gribben¹

¹Centre for Haemato-Oncology, ²Centre for Tumour Biology, Barts Cancer Institute, London, ³Cancer Sciences Division, University of Southampton, Southampton, United Kingdom

LYS-P-27

Clinicopathologic Features of Lymphoma in Spinal Epidural Space

Kai Zhang¹
¹Medical Laboratory, Geisinger Health System, Danville, United States

LYS-P-28

MYC gene alterations and not BRAF and MAPK mutations are common features in dendritic cell neoplasms

Gerard Frigola¹, Iban Aldecoa¹, Natalia Papaleo², Elías Campo¹, Lluís Colomo², Olga Balagué¹
¹Pathology Department, Hospital Clínic, ²Pathology Department, Hospital del Mar, Barcelona, Spain

Poster Presentations

Lymphoma

LYS-P-29

Double hit lymphoma identification and characterization in routine practice

Olga Balagué¹, Marta Marginet¹, Anna Carrió², Dolors Costa², Blanca González¹, Alfredo Rivas³, Cristina Teixidó¹, Adriana Sierra¹, Antonio Martínez¹, Elías Campo¹

¹Pathology, ²Citogenetics, ³Hematology, Hospital Clinic. University of Barcelona, Barcelona, Spain

LYS-P-30

Clinicopathologic characteristics and novel biomarkers of aggressive B-cell lymphomas in the nasopharynx

Po-Han Chen¹, Yuhang Yang², Dennis P. O'Malley², Mina Xu¹

¹Pathology, Yale-New Haven Hospital, New Haven, ²Neogenomics, Aliso Viejo, United States

LYS-P-31

Burkitt-like lymphoma with 11q aberration is not uncommon in children

Shunyou Gong¹, Melissa Stalling², Aroop Kar², Madina Sukhanova³, Girish Venkataraman³, Katrin Leuer², Lawrence Jennings², Kristian Schafernak⁴, Nobuko Hijija²

¹Pathology, ²Northwestern University, ³University of Chicago, Chicago, ⁴Phoenix Children's Hospital, Phoenix, United States

LYS-P-32

Impact of Sox11 overexpression in Ba/F3 cells

Birgitta Sander¹, Martin Lord¹, Gustav Arvidsson¹, Agata M. Wasik¹, Birger Christensson¹, Anthony P. Wright¹, Alf Grandien²

¹Laboratory Medicine, ²Medicine, Karolinska Institutet, Stockholm, Sweden

LYS-P-33

Expression of P63 and absence of GATA3 are useful surrogate markers to differentiate primary mediastinal large B-cell lymphoma from classic Hodgkin lymphoma

Hyun-Jung Kim¹, Geongsin Park², Jae Ho Han³, Hee Kyung Kim⁴, Hee Jung Cha⁵, Dae Woon Eom⁶, Uiju Cho⁷, Suk Jin Choi⁸, Soo Kee Min⁹, Ji Eun Kim¹⁰

¹Pathology, Inje University Sanggye Paik Hospital, ²Pathology, Seoul St. Mary's Hospital, The Catholic Univ, Seoul, ³Pathology, Ajou Univ, Suwon, ⁴Pathology, Soonchunhyang University Bucheon Hospital, Bucheon, ⁵Pathology, Ulsan University Hospital, Ulsan, ⁶Pathology, Gangneung Asan Hospital, Gangneung, ⁷Pathology, St. Vincent Hospital, Suwon, ⁸Pathology, Inha University Hospital, Incheon, ⁹Pathology, Hallym University Sacred Heart Hospital, Anyang, ¹⁰Pathology, Seoul National University Boramae Hospital, Seoul, Korea, Republic Of

LYS-P-34

Contribution of immunoglobulin lambda light chain gene rearrangement analysis in the diagnosis of lymphoproliferative disorders

Anna Paterson¹, Hesham Eldaly^{2,3}, Livia Raso-Barnett², Ming-Qing Du⁴, Olivier Giger⁴, Elizabeth Soilleux⁴, Thomas Robert², Yuanxue Huang², Hani Bibawi², Baljinder Matharu², Anthony Bench², Mike Scott², Hongxiang Liu²

¹Department of Histopathology, ²Haematopathology and Oncology Diagnostics Service, Cambridge University Hospitals NHS Foundation Trust, Cambridge, United Kingdom, ³Clinical Pathology Department, Cairo University, Cairo, Egypt, ⁴Department of Pathology, University of Cambridge, Cambridge, United Kingdom

LYS-P-36

The spectrum of findings in patients presenting with extranodal marginal zone B-cell lymphoid proliferations of mucosa associated lymphoid tissue (MALT) in the recto-colonic mucosa

Lori Soma¹, Stephen Smith², Prathima Reddy², Sindhu Cherian¹, David Wu¹, Kerstin Edlefsen¹, Xueyan Chen¹, Yi Zhou¹, Jonathan Fromm¹

¹Department of Laboratory Medicine, ²Department of Hematology-Oncology, University of Washington, Seattle, United States

Poster Presentations

Lymphoma

LYS-P-37

Mycosis Fungoides in Taiwan shows a relatively high frequency of large cell transformation and CD56 expression

Ren Ching Wang¹, Shih-Sung Chuang²

¹Pathology and Laboratory Medicine, Taichung Veteran General Hospital, Taichung, Taiwan, Taichung city, ²Pathology, Chi-Mei Medical Center, Tainan, Taiwan

LYS-P-38

Diagnostic yield of nerve biopsy in neurolymphomatosis: pathology and PCR-based clonality testing. A serie of 15 cases

Mathilde Duchesne^{1,2}, Olivier Roussellet³, Thierry Maisonobe⁴, Nathalie Gachard⁵, Marine Armand⁶, Laurence Richard², Arnaud Jaccard⁷, Jean-Michel Vallat², Laurent Magy^{2,3}

¹Pathology, ²Laboratory of Neurology, ³Neurology, University Hospital of Limoges, Limoges, ⁴Clinical Neurophysiology, University Hospital La Pitié-Salpêtrière, Paris, ⁵Biological Hematology, University Hospital of Limoges, Limoges, ⁶Biological Hematology, University Hospital La Pitié-Salpêtrière, Paris, ⁷Hematology, University Hospital of Limoges, Limoges, France

LYS-P-39

WHO Classification of Malignant lymphomas in Korea: Report of the 4th Nationwide study

Kim Hyun-Jung¹, Hye Ra Jung², Ji Eun Kim³, Geongsin Park⁴, Jae Ho Han⁵, Dae Woon Eom⁶, Hee Jung Cha⁷, Young-Hye Ko⁸, Jooryung Huh⁹, Yoon Kyung Jeon¹⁰, Sun Och Yoon¹¹, Young-A Kim¹², Jin Ho Paik¹³, Ji-Young Choe¹⁴, Soo Kee Min¹⁵, Hee Kyung Kim¹⁶, Wook Youn Kim¹⁷, Suk Jin Choi¹⁸, Seung-Sook Lee¹⁹

¹Inje Univ. Sanggye Paik Hospital, Seoul, ²Department of Pathology, Keimyung University Dongsan Medical center, Daegu, ³Department of Pathology, Seoul National Univ. Boramae Hospital, ⁴Department of Pathology, Seoul St. Mary's Hospital, The Catholic Univ., Seoul, ⁵Ajou Univ, Suwon, ⁶Department of Pathology, Gangneung Asan Hospital, Gangneung, ⁷Department of Pathology, Ulsan Univ, Ulsan, ⁸Department of Pathology, Samsung Medical Center, ⁹Department of Pathology, Asan Medical Center, ¹⁰Department of Pathology, Seoul National University, ¹¹Department of Pathology, Yonsei University Severance hospital, ¹²Department of Pathology, Seoul National University, Boramae Hospital, ¹³Department of Pathology, Seoul National University Bundang Hospital, Seoul, ¹⁴Department of Pathology, Hallym University Sacred Heart Hospital, Anyang, Anyang, ¹⁵Department of Pathology, Hallym University Sacred Heart Hospital, Anyang, Anyang, ¹⁶Department of Pathology, Soonchunhyang University Bucheon Hospital, Bucheon, ¹⁷Department of Pathology, Konkuk University, Seoul, ¹⁸Department of Pathology, Inha University, Incheon, ¹⁹Department of Pathology, Korea cancer center hospital, Seoul, Korea, Republic Of

LYS-P-40

Hypoxia and the immune microenvironment of DLBCL: HIF1a, HIF2a, and PDL1 immunohistochemical expression and clinical outcome analysis

Vladislav Makarenko¹, Karen Dresser¹, Benjamin J. Chen¹

¹Pathology, University of Massachusetts Medical School, Worcester, United States

Poster Presentations

Lymphoma

LYS-P-41

Cutaneous B-Cell Lymphoma: A Retrospective Clinicopathological Evaluation of 92 CasesDerya Demir¹, Nazan Ozsan¹, Banu Yaman¹, Taner Akalin¹, Mine Hekimgil¹¹Department of Pathology, Ege University Faculty of Medicine, Izmir, Turkey

LYS-P-42

Frequency of high-grade B cell lymphomas with diffuse large B cell morphology detected by FISH study (MYC,BCL2,BCL6) with relevance of double-expressor or non-double-expressor phenotype. A clinical-pathological correlation in 210 Mexican casesCarmen Lome-Maldonado¹, Paulina Elizabeth Santana-Vargas¹, Deissy Roxana Quezada-López¹, Renata Rivera-Juárez¹, Dolores Nava-Espinal¹, Diego Armando Zúñiga-Tamayo¹, Silvia Rivas-Vera², Hugo Arturo González-Martínez¹, Martha Lilita Moreno-Martínez¹, Darwin David Pérez-Rodríguez¹, Víctor Hugo Olivera-Rodríguez¹, Arturo Angeles-Angeles³,Ana Florencia Ramírez-Ibarguen¹
¹Pathology, ²Hematology, Instituto Nacional de Cancerología, ³Pathology, Instituto Nacional de Ciencias Medicas y Nutricion Salvador Zubiran, Mexico D.F., Mexico

LYS-P-43

Mutational analysis using NGS shows frequent targetable mutations in double-hit and triple-hit high grade B-cell lymphoma (HGBL) and detects TNFAIP3 mutations in transformed casesSarah Medane¹, Cedric Pastoret², Aline Moignet Autrel³, Marc-Antoine Belaud-Rotureau⁴, Thierry Fest⁵, Thierry Lamy de la Chapelle³, Roch Houot³, Francisco J. Llamas Gutierrez¹¹Anatomie et Cytologie Pathologiques, ²Laboratoire d'hématologie cellulaire, ³Hématologie Clinique, ⁴Service de cytogénétique et biologie cellulaire, ⁵Université de Rennes 1, INSERM U917, hematobiologique CHU Pontchaillou, CHU de Rennes, Rennes, France

LYS-P-44

Incidence of Hodgkin and non-Hodgkin lymphoma in HIV positive patients. High incidence of Epstein Barr virus coinfection in a Mexican populationDiego Armando Zúñiga-Tamayo¹, Dolores Nava-Espinal¹, Brenda Acosta-Maldonado², Ana Florencia Ramírez-Ibarguen², Patricia Volkow-Fernández³, Ana Janeth Salazar-Vargas¹, Deissy Roxana Quezada-López¹, Hannali Quintero-Buenrostro¹, Ingrid Karla Freeze-Gallardo¹, Diana Karen Cante-Lima¹, Arturo Angeles-Angeles⁴, Carmen Lome-Maldonado¹¹Pathology, ²Hematology, ³Infectology, Instituto Nacional de Cancerología, ⁴Pathology, Instituto Nacional de Ciencias Medicas y Nutricion Salvador Zubiran, Mexico D.F., Mexico

LYS-P-45

Diagnostic Utility of LMO2 and CD38 as an Immunohistochemical Panel in Distinguishing Burkitt lymphoma from other aggressive B-cell lymphomasYifei Liu^{1,2}, Tingting Bian², Jianguo Zhang², Jianlan Xie¹, Yanlin Zhang¹, Xiaoge Zhou¹¹Pathology, Beijing Friendship Hospital, Capital Medical University, Beijing, ²Pathology, Affiliated Hospital of Nantong University, Nantong, China

LYS-P-46

Comparison of the Lymph2Cx assay and Hans algorithm in determining the Cell-Of-Origin of diffuse large B-cell lymphomasInju Cho^{1,2}, Nara Yoon³, Jiyeon Hyeon², Jongmin Sim², Soomin Ahn⁴, Hae Yong Yoo⁵, Suk Jin Kim⁶, Won Seog Kim⁶, Young Hyeon Ko²¹Department of Hospital Pathology, Yeouido St. Mary's Hospital, ²Department of Pathology and Translational Genomics, Samsung Medical Center, Seoul, ³Incheon St Mary's hospital, Incheon, ⁴Department of pathology, Seoul National University Bundang Hospital, Seongnam, ⁵Department of Health Sciences and Technology, Samsung Advanced Institute for Health Sciences and Technology, ⁶Division of Hematology and Oncology, Department of Medicine, Samsung Medical Center, Seoul, Korea, Republic Of

Poster Presentations

Lymphoma

LYS-P-47

CD30-expression in neoplastic T cells of follicular T-cell lymphoma is a helpful diagnostic tool in the differential diagnosis to Hodgkin lymphomaSylvia Hartmann¹, Olga Goncharova¹, Anna Portyanko², Elena Sabattini³, Jörn Meinel⁴, Ralf Küppers⁵, Claudio Agostinelli³, Stefano Pileri⁶, Martin-Leo Hansmann¹¹Goethe Universität, Frankfurt, Germany, ²National Cancer Center, Minsk, Belarus, ³University of Bologna, Bologna, Italy, ⁴Carl Gustav Carus University Dresden, Dresden, ⁵University of Duisburg-Essen, Essen, Germany, ⁶European Institute of Oncology, Milan, Italy

LYS-P-48

Primary gastrointestinal lymphomas: A four year study of 152 cases from a tertiary cancer centre in South IndiaRekha Appukuttan Nair¹, Renu Sukumaran¹, Priya M. Jacob¹, Jayasudha Vasudevan¹¹Pathology, Regional Cancer Centre Trivandrum, Trivandrum, India

LYS-P-49

The Contribution and Role of Clonality Studies in the Diagnosis of Lymphoproliferative Disorders – A Tertiary-Centre's ExperienceAnna Paterson¹, Hongxiang Liu², Hesham Eldaly^{2,3}¹Department of Histopathology, ²Haematopathology and Oncology Diagnostics Service, Cambridge University Hospitals NHS Foundation Trust, Cambridge, United Kingdom, ³Clinical Pathology Department, Cairo University, Cairo, Egypt

LYS-P-50

Leukemic presentation of small cell variant of ALK+ALCL with a novel p Primary CD5-positive diffuse large artner PABPC1, responding to single-agent crizotinib treatmentDylan Graetz¹, Kristine Crews², Susana Raimondi³, John Mason³, Elizabeth Azzato³, Hiroto Inaba¹, Vasiliki Leventaki^{1,3}¹Oncology, ²Pharmaceutical Sciences, ³Pathology, St. Jude Children's Research Hospital, Memphis, United States

LYS-P-51

Peripheral T-cell lymphoma, no's: Prognostic value of the association with infection EBV in Peruvian poblacionDaniela E. Dueñas^{1,2}, Santiago Montes³, Sandro Casavilca², Miguel Angel Piris⁴, Carlos Barrionuevo²¹Translational Molecular Path, MD Anderson Cancer Center, Houston, ²Instituto Nacional de Enfermedades Neoplasicas, Lima, Peru, ³Universidad de Valdecilla, Santander, ⁴Fundacion Jimenez Diaz, Madrid, Spain

LYS-P-52

PD-1 and PD-L1 expression in a small series of cases within the spectrum of CD30 positive cutaneous lymphoproliferative disordersAslihan Yavas¹, Fadime G. Salman¹, Aylin O. Heper¹, Isinsu Kuzu¹, Bengu N. Akay², Hatice Sanli², Sinem Bozdag³, Gulsah Kaygusuz¹¹Department of Pathology, ²Department of Dermatology, ³Department of Hematology, Ankara University Faculty of Medicine, Ankara, Turkey

LYS-P-53

Prognostic value of PD-L1 expression and EBV association in patients with primary intestinal diffuse large B-cell lymphomaEri Ishikawa^{1,2}, Seiichi Kato³, Akira Satou⁴, Kei Kohno², Kazuyuki Shimada⁵, Masanao Nakamura¹, Yoshiki Hirooka⁶, Shigeo Nakamura²¹Gastroenterology and Hepatology, Nagoya University Graduate School of Medicine, ²Pathology and Laboratory Medicine, Nagoya University Hospital, ³Pathology and Molecular Diagnostics, Aichi Cancer Center Hospital, ⁴Surgical Pathology, Aichi Medical University, ⁵Hematology and Oncology, Nagoya University Graduate School of Medicine, ⁶Endoscopy, Nagoya University Hospital, Nagoya, Japan

Poster Presentations

Lymphoma

LYS-P-54

The role of activated stromal cells in onset of inflammation associated lymphoma: A case reportRodothea Amerikanou¹, Richard Burt², Sabine Pomplun³¹Haematology Department, Royal Free Hospital, ²Haematology Department, University College London, ³Pathology Department, University College London Hospitals, London, United Kingdom

LYS-P-55

Adaptation to hypoxia is marked by carbonic anhydrase IX expression in Hodgkin-Reed-Sternberg-cells and is associated with unfavourable response to therapy in classical Hodgkin's lymphomaGábor Méhes¹, Orsolya Matolay¹, Marianna Czenke¹, Lívia Beke¹, Arpad Illés², Judit Bedekovics¹¹Department of Pathology, ²Institute of Internal Medicine, Department of Hematology, University of Debrecen, Debrecen, Hungary

LYS-P-56

Cytokeratin-positive fibroblastic reticular cell tumor with focal follicular dendritic cell features: A case reportJi Yun Jeong¹, Jeong Ju Lee², Tae-In Park³, Young-Hyeh Ko⁴¹Pathology, ²Surgery, Kyungpook National University Chilgok Hospital, Kyungpook National University, School of Medicine, ³Pathology, Kyungpook National University Hospital, Kyungpook National University, School of Medicine, Daegu, ⁴Pathology, Samsung Medical Center, Sungkyunkwan University School of Medicine, Seoul, Korea, Republic Of

LYS-P-57

Primary extranodal lymphomas in Kerala, South IndiaJayasudha A. Vasudevan¹, Rekha A. Nair¹, Renu Sukumaran¹, Priya M. Jacob¹, Sreejith G. Nair²¹Pathology, ²Medical Oncology, Regional Cancer Centre, Thiruvananthapuram, India

LYS-P-58

Lymphomas of the gut: 18 years' experience on 103 casesMine Hekimgil¹, Derya Demir¹, Nazan Özsan¹, Hafize Ozdemir¹, Murat Sezak¹, Basak Doganavsargil¹¹Department of Pathology, Ege University Faculty of Medicine, Izmir, Turkey

LYS-P-59

Myc expression in primary central nervous system lymphomaJoanna Reszec¹, Janusz Dzieciol², Zofia D. Anikiej², Robert Rutkowski³¹Dep. of Medical Pathology, ²Dep. of Human Anatomy, ³Dep. of Neurosurgery, Uniwersytet Medyczny w Białymstoku, Białystok, Poland

LYS-P-60

Clinicopathologic comparison of initial versus secondary hematomalymphoid malignant diagnosis made on effusion samplesAtif Saleem¹, Dita Gratzinger²¹Pathology, ²Stanford, Stanford, United States

LYS-P-61

Identifying the nature of Perforation in patients diagnosed with Gastrointestinal Lymphoma. Do we need early interventions?Arooj Fatima¹, Syed Sammar Abbas Zaidi²¹SKMC & RC, ²wecare medical centre, Lahore, Pakistan

LYS-P-62

Primary classical Hodgkin lymphoma of the skin, A case reportBarbara Gazic¹, Gorana Gasljevic¹, Biljana Grcar Kuzmanov¹, Mojca Gjidera¹¹Pathology, Institute of oncology Ljubljana, Ljubljana, Slovenia

Poster Presentations

Lymphoma

LYS-P-63

Primary extranodal non-Hodgkin lymphoma in the North-Western region of Romania: clinicopathological features and survivalBogdan Fetica¹, Bogdan Pop¹, Mihaiela L. Blaga¹, Ovidiu Coza¹, Mihnea Zdrenghea², Ciprian Tomuleasa², Daniela Coza¹, Alexandru Irimie²¹The "Prof. Dr. Ion Chiricuta" Institute of Oncology, ²University of Medicine and Pharmacy "Iuliu Hatieganu", Cluj-Napoca, Romania

LYS-P-64

Clinicopathologic analysis of splenic lymphoma: Three year experienceMiljan Krstic^{1,2}, Maja Peruničić Jovanović³, Slavica Stojnev⁴, Petar Jovanović⁵, Ivan Petković^{6,7}, Darko Antić^{8,9}¹Department of Pathology, Faculty of Medicine, University of Nis, ²Centre for Pathology, Clinical Centre Nis, Niš, ³Department of Pathology, Clinical Centre of Serbia, Belgrade, ⁴Department of Pathology, Medical Faculty, University of Nis, Niš, ⁵Faculty of Medicine, University of Priština, Kosovska Mitrovica, ⁶Department of oncology, Faculty of Medicine, University of Nis, ⁷Clinic for oncology, Clinical Centre Nis, Niš, ⁸Faculty of Medicine, University of Belgrade, ⁹Clinic for Haematology, Clinical Centre of Serbia, Belgrade, Serbia

LYS-P-65

Primary classic Hodgkin Lymphoma in unusual sitesHowayda S. Abd El Ali^{1,2}¹Pathology, Suez Canal University, Faculty of Medicine, Ismailiya, ²IHC lab, Nasser Institute, Cairo, Egypt

LYS-P-66

Risk of malignant neoplasms of blood and lymphatic system of liquidators of the Chernobyl accident in BelarusIlya Veyalkin¹, Andrei Cheshyk²¹Laboratory Epidemiology, ²Chernobyl Registry, Research Center for Radiation Medicine and Human Ecology, Gomel, Belarus

LYS-P-67

Identifying the types of Non-hodgkin LymphomaArooj Fatima¹, syed sammar abbas Zaidi²¹SKMC & RC, ²wecare medical centre, Lahore, Pakistan

LYS-P-68

NFATc1 and tumor micro environment in diffuse large B cell lymphomaKrisna Murti¹, Muslina Muslina¹¹Anatomic Pathology, Faculty of Medicine University of Sriwijaya, Palembang, Indonesia

LYS-P-69

Presence of Epstein – Barr virus and Lack of Existence of Simian Virus 40 Deoxyribonucleic Acid Sequences in Paraffin Embedded Tissue of Diffuse Large B cell Lymphoma Cases in Yogyakarta IndonesiaNungki Anggorowati¹, Wahyu T. Widayati¹, Nugira Dinantia¹, Restanti A. Novitasari¹, Dewajani Purnomosari², Kartika Widayati³, Indrawati FNU¹¹Anatomical Pathology, Faculty of Medicine, Universitas Gadjah Mada/Sardjito Hospital, ²Histology and Cell Biology, Faculty of Medicine, Universitas Gadjah Mada, ³Internal Medicine, Faculty of Medicine, Universitas Gadjah Mada/Sardjito Hospital, Sleman, Indonesia

LYS-P-70

Gluteal-implant associated anaplastic large cell lymphoma: a case report and proposal for a new terminologyFlávia Zacchi¹, Jussara Castelli¹, Mônica Stiepcich¹, José Mendes Jr², Vinicius Maykeh²¹Pathology, Fleury Group, São Paulo, ²Brazilian Society of Plastic Surgery, Sorocaba, Brazil

LYS-P-71

Cyclin D1 expression in lymphoproliferative neoplasms by flow cytometry and immunohistochemistryShano Naseem¹, Alaknanda Walia¹, Man U. Sachdeva¹, Neelam Varma¹¹Hematology, Pgimer, Chandigarh, India

Poster Presentations

Lymphoma

LYS-P-72

Evaluation of the role of Interleukin-6 and Hepcidin in Anemia in patients with LymphomaAlauldeen M. Z. Alqasim¹, Yusur F. Bdaiwi²¹Pathology, University of Mustansiriyah/Faculty of Medicine, ²Teaching Laboratories, Medical City, Baghdad, Iraq

LYS-P-73

The expression of Human Telomerase Reverse Transcriptase gene and its activity in patients with B-Cell chronic lymphocytic leukemia and its impact on clinical stagingAli Aljabban¹, Jaffar Alalsaidissa¹¹Department of Pathology, Baghdad College of Medicine, Baghdad, Iraq

LYS-P-74

Enhancer of zeste homolog 2 (EZH2) expression and its association with MYC regulation in follicular lymphoma as a prognostic biomarkerAnna Szumera-Cieckiewicz^{1,2}, Kamil Sokol^{1,2}, Maria Chraszczewska^{1,2}, Anita Jastrzebska³, Grzegorz Rymkiewicz³, Urszula Wojciechowska³, Joanna Didkowska³, Ewa Paszkiewicz-Kozik³, Jan Walewski³, Monika Prochorec-Sobieszek^{1,2}¹Diagnostic Hematology Department, Institute of Hematology and Transfusion Medicine, ²Department of Pathology and Laboratory Medicine, Maria Skłodowska-Curie Memorial Cancer Center and Institute of Oncology, ³Maria Skłodowska-Curie Memorial Cancer Center and Institute of Oncology, Warsaw, Poland

LYS-P-75

Plasmablastic lymphoma, a single center experience on 22 casesNazan Özsan¹, Derya Demir¹, Ayse Uysal², Mahmut Tobu², Mine Hekimgil¹¹Department of Pathology, ²Department of Hematology, Ege University Faculty of Medicine, Izmir, Turkey

LYS-P-76

A case of primary central nervous system histiocytic sarcoma with prominent proliferation of histiocytic cells between the trabeculae of reactive glial cellsEmiko Takahashi¹, Shigeo Nakamura²¹Department of Surgical Pathology, Aichi Medical University Hospital, Nagakute, ²Department of pathology, Nagoya University Hospital, Nagoya, Japan

LYS-P-77

The brain and the lymphoma – not so uncommon friendshipTihomir Dikov¹, Milan Jagurinoski¹, Yavor Topalov¹, Branimir Spassov², Gueorgui Balatzenko³, Margarita Guenova¹¹Laboratory of Hematopathology and Immunology, ²Hematology Clinic, ³Laboratory of Cytogenetics and Molecular Biology, NATIONAL SPECIALISED HOSPITAL FOR ACTIVE TREATMENT OF HEMATOLOGICAL DISEASES, Sofia, Bulgaria

LYS-P-78

Prognostic role of MAPK/ERK signal pathway alterations in patients with Langerhans Cell Histiocytosis: Update resultsOlga Novosad¹, Tetiana Skrypets¹, Ian Pastushenko¹, Oksana Skachkova², Mariia Inomistova², Olexandr Gorbach², Nataliia Khranovska², Irina Kryachok¹¹Oncohematology, ²Experimental Oncology, National Cancer Institute, Kiev, Ukraine

LYS-P-79

Unusual presentation of indolent T-cell lymphoproliferative disorder of the gastrointestinal tract involving full thickness of the colonJi Yun Jeong¹, Jeong Ju Lee², Tae-In Park³, Young-Hyeh Ko⁴¹Pathology, ²Surgery, Kyungpook National University Chilgok Hospital, Kyungpook National University, School of Medicine, ³Pathology, Kyungpook National University Hospital, Kyungpook National University, School of Medicine, Daegu, ⁴Pathology, Samsung Medical Center, Sungkyunkwan University School of Medicine, Seoul, Korea, Republic Of

Poster Presentations

Lymphoma

LYS-P-80

A case of primary pulmonary extranodal marginal zone lymphoma of mucosa-associated lymphoid tissue with amyloidosisToko Miyazaki¹, Satoshi Ota², Emiko Sakaida³¹Medicine, ²Pathology, ³Hematology, Chiba University, Chiba-ken, Japan

LYS-P-81

Transfusion associated complications during bone marrow transplantation in Diffuse Large B-Cell Lymphoma patientsAmbreen Sheikh¹, Syed A. Ali²¹Pathology, DUHS, ²A and E, Dr Ziauddin Hospital, Karachi, Pakistan

LYS-P-82

Prolonged clinical remission after rituximab treatment in cases of acquired angioedemaPetros Fessas¹, Sanja Ugrinovic², Ariharan Anantharachagan², Dinakantha S. Kumararatne²¹School of Clinical Medicine, University of Cambridge, ²Department of Clinical Biochemistry, University of Cambridge, Cambridge, United Kingdom

LYS-P-83

Extranodal NK/T-cell lymphoma of the small intestine in a pediatric patientXiayuan Liang¹, Adam C. Wilberger² and University of Colorado School of Medicine, Children's Hospital Colorado¹Pathology, University of Colorado School of Medicine, Children's Hospital Colorado, ²Pathology, University of Colorado School of Medicine, Aurora, United States

LYS-P-84

Leukemic presentation of Anaplastic large cell lymphoma, ALK-positive: report of a case and brief review of literatureJussara B. Castelli^{1,2}, Flavia Zacchi², Matheus Gonçalves³, Alex Sandes³, Yana Novis⁴, Maria de Lourdes Chauffaille³¹Pathology, Hospital das Clínicas – FMUSP, ²Pathology, ³Hematology, Grupo Fleury, ⁴Hematology, Hospital Sírio-Libanês, Sao Paulo, Brazil

LYS-P-85

Non-Hodgkin lymphoma secondary to Hodgkin lymphoma in an Adult Patient with Nijmegen Breakage SyndromeJulia Slotta-Huspenina¹, Krischan Braitsch², Tibor Vag³, Ulrich Keller²¹Institute of Pathology, ²Internal Medicine III, School of Medicine, ³Department of Nuclear Medicine, School of Medicine, Technical University of Munich, Munich, Germany

LYS-P-86

Clinico-histomorphological correlation of Epstein Barr Virus in Hodgkin's LymphomaPreeti Rani¹, Mili Jain², A.K. Tripathi³, Ashutosh Kumar⁴¹Junior resident, Department of Pathology, ²Assistant professor, Department of Pathology, ³Professor, Department of Clinical Haematology, ⁴Professor, Department of Pathology, King George Medical University, Lucknow, India

LYS-P-87

EBV-positive NK/T-cell lymphoma, associated with chronic active EBV infection: A case reportJi Yun Jeong¹, Jeong Ju Lee², Tae-In Park³, Young-Hyeh Ko⁴¹Pathology, ²Surgery, Kyungpook National University Chilgok Hospital, Kyungpook National University, School of Medicine, ³Pathology, Kyungpook National University Hospital, Kyungpook National University, School of Medicine, Daegu, ⁴Pathology, Samsung Medical Center, Sungkyunkwan University School of Medicine, Seoul, Korea, Republic Of

LYS-P-88

A Case Report of Myeloproliferative Neoplasms Following Treatment of Myeloid Sarcoma Presenting as Spleen and Splenic lymph node tumorsMegumi Nakanishi¹, Satoshi Ota², Masahiro Takeuchi³, Yuri Kawashima⁴, Nobuyuki Aotsuka⁴, Emiko Sakaida³, Yukio Nakatani²¹Chiba Univ., Chiba prefecture, Japan, ²Dept. Pathol., ³Dept. Hematol., Chiba Univ., ⁴Dept. Hematol., Japanese Red Cross Society Hosp., Chiba prefecture, Japan

Poster Presentations

Lymphoma

LYS-P-89

Non-Hodgkin lymphoma simulating carcinoma of the vulvar region: Report of two cases

Daniela E. Dueñas^{1,2}, Daniel Enriquez³, Luis Taxa³, Patricia Webb³, Jaime Montes², Carlos Barrionuevo²
¹Translational Molecular Path, MD Anderson Cancer Center, Houston, United States, ²Instituto de Enfermedades Neoplásicas, ³Instituto de Enfermedades Neoplásicas, Lima, Peru

LYS-P-90

Solitary extramedullary plasmacytoma of the liver in a 26-years old woman

Tihomir Dikov¹, Valentina Madzharova¹, Gueorgui Balatzenko², Branimir Spassov³, Margarita Guenova¹
¹Laboratory of Hematopathology and Immunology, ²Laboratory of Cytogenetics and Molecular Biology, ³Hematology Clinic, National specialised hospital for active treatment of hematological diseases, Sofia, Bulgaria

LYS-P-91

Sex privileged or site privileged lymphomas, a gender comparison

Tihomir Dikov¹, Milan Jagurinoski¹, Yavor Topalov¹, Branimir Spassov², Gueorgui Balatzenko³, Margarita Guenova¹
¹Laboratory of Hematopathology and Immunology, ²Hematology Clinic, ³Laboratory of Cytogenetics and Molecular Biology, NATIONAL SPECIALISED HOSPITAL FOR ACTIVE TREATMENT OF HEMATOLOGICAL DISEASES, Sofia, Bulgaria

LYS-P-92

A potential pitfall in lymph node biopsy and cytology: CD30+ ALK- large B-cell "sticky" lymphoma mimicking metastatic carcinoma

Masaru Hosone¹, Satoru Arai¹, Hironori Katayama¹, Yumi Yanagida¹, Norio Yumoto¹, Zenya Naito¹
¹Pathology, Nippon Medical School, Tokyo, Japan

LYS-P-93

Autoimmune Lymphoproliferative Syndrome: suspected diagnosis from the lymph node biopsy of a child with generalized lymphadenopathy

Flávia Zacchi¹, Jussara Castelli¹, Vaneska Jardini², Matheus Gonçalves³
¹Pathology, Fleury Group, São Paulo, ²Hematology, CTFM/GACC, São José dos Campos, ³Hematology, Fleury Group, São Paulo, Brazil

LYS-P-94

Nodular lymphocyte predominance Hodgkin lymphoma (NLPHL) or T cell rich B cell lymphoma (TCRBCL), a diagnostic challenge

Howayda S. Abd El All^{1,2}
¹Pathology, Suez Canal University, Faculty of Medicine, Ismailiya, ²IHC lab, Nasser Institute, Cairo, Egypt

LYS-P-95

Flow cytometric Immunophenotyping of Peripheral T cell Neoplasms in Yemen

Saleh Abuhadi¹, Wendy Erber²
¹Flow cytometry, National Oncology Center, Sana'a, Yemen, ²Faculty of medicine, The University of Western Australia, Perth, Australia

LYS-P-96

Intravascular large B-cell lymphoma with relapsing postchemotherapy, treated by stem cell transplant

Ayumu Tsubosaka¹, Satoshi Ota², Tatsuzo Mishina³, Chikako Ohwada³, Yusuke Takeda³, Emiko Sakaida³, Yukio Nakatani^{1,2}
¹Dep. of Diagnostic Pathol., Chiba Univ. Grad. Sch. of Med., ²Dep. of Pathol., ³Dep. of Hematol., Chiba Univ. Hosp., Chiba, Japan

LYS-P-97

Primary CD5-positive diffuse large B-cell lymphoma of the brain: Case report

Daniela E. Dueñas^{1,2}, Carlos Pachas³, Sandro Casavilca², Enrique Orrego², Carlos Barrionuevo²
¹MD Anderson Cancer Center, Houston, United States, ²Instituto Nacional de Enfermedades Neoplásicas, ³Hospital Central Policia Nacional del Peru, Lima, Peru

Acknowledgements

We gratefully acknowledge the support of the following sponsors:

Platinum Sponsors



Celgene



Takeda Oncology and Seattle Genetics

Gold Sponsors



Janssen Pharmaceuticals

Silver Sponsors



3DHISTECH



Illumina

Bronze Sponsors



Ventana Roche

Other Sponsors

- Agilent Technologies Ltd.
- Leica
- Invivoscribe

1 October 2018 | 17.00-18.30

Edinburgh International Conference Centre,
Room Pentland

Cell of Origin testing in DLBCL: a new paradigm towards precision medicine

Chair: Stefan Dirnhofer (Switzerland)

Faculty:

Greg Nowakowski (USA)
Cathy Burton (UK)
Elias Campo (Spain)
Stefan Dirnhofer (Switzerland)



Satellite symposium at the 19th Meeting of the European Association for Haematopathology. This symposium is organized and funded by Celgene.

Sponsored Satellite Symposia

Sunday, 30 September 2018

Pentland Auditorium SPONSORED SATELLITE SYMPOSIUM

18.30–19.30 **llumina** **Future of Genomic Testing in Hematological Malignancies**

Clinical implementation of whole-genome sequencing in hematological malignancies: are we there yet?

R. Rosenquist, Stockholm, Sweden

Whole genome sequencing and Artificial Intelligence – where are we heading?

M. Meggendorfer, Munich, Germany

Fintry SPONSORED SATELLITE SYMPOSIUM

18.30–19.30 **Leica Biosystems Ltd** **Accurate and Timely Diagnostic Solutions – A Comparative Study of IHC Systems**

Moderator: C. Rhoades, Newcastle, UK

Accurate and Timely Diagnostic Solutions – A Comparative Study of IHC Systems

C. Rhoades, Newcastle, UK

Monday, 1 October 2018

Pentland Auditorium SPONSORED SATELLITE SYMPOSIUM

13.30–14.30 **Seattle Genetics and Takeda** **CD30: Informing Diagnosis and Treatment in CTCL and PTCL**

13.30–13.35 Welcome and introduction
A. Gru, Virginia, USA

13.35–13.55 CD30 testing: differential diagnoses and decision-making
J. Pawade, Bristol, UK
A. Gru, Virginia, USA

13.55–14.15 A practical guide to CD30 testing in the management of CTCL and PTCL
J. Pawade, Bristol, UK
A. Gru, Virginia, USA

14.15–14.25 Ask the experts: a Q&A session
J. Pawade, Bristol, UK
A. Gru, Virginia, USA

14.25–14.30 Summary and close
J. Pawade, Bristol, UK

Sponsored Satellite Symposia

Monday, 1 October 2018

Pentland Auditorium SPONSORED SATELLITE SYMPOSIUM

17.00–18.30 **Celgene** **Cell of Origin testing in DLBCL: a new paradigm towards precision medicine**

Moderator: S. Dirnhofer, Switzerland

Clinical experience with CoO stratified trials in DLBCL
G. Nowakowski, USA

GEP tools in CoO testing
C. Burton, UK

Practical implementation of CoO testing in real life
E. Campo, Spain

CoO testing in the WHO 2016 classification and ESMO guidelines: practical consequences
S. Dirnhofer, Switzerland

Closing
S. Dirnhofer, Switzerland

Tuesday, 2 October 2018

Pentland Auditorium SPONSORED SATELLITE SYMPOSIUM

13.30–14.30 **Janssen** **Precision Medicine in lymphoid malignancies: transferring scientific insight into clinical practice**

Moderator: K. Stamatopoulos, Thessaloniki, Greece

Introduction
K. Stamatopoulos, Thessaloniki, Greece

The impact of genomics on understanding the pathogenesis of hematological malignancies
E. Campo, Barcelona, Spain

Genomics in routine diagnostics of hematological malignancies
R. Rosenquist, Stockholm, Sweden

Applying advances in scientific understanding in the clinic
K. Stamatopoulos, Thessaloniki, Greece

Panel discussion
All

Exhibition Floor Plan

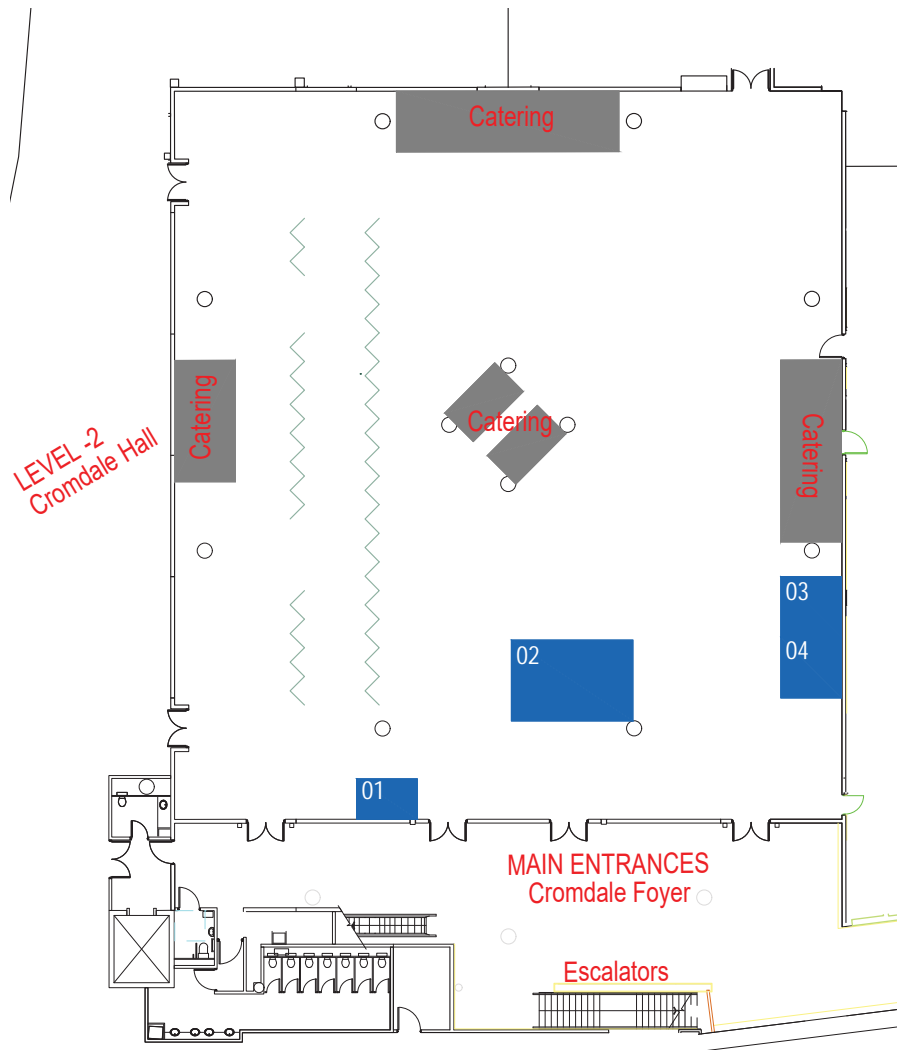

No.	Company Name	No.	Company Name
01	Inivoscribe	03	AGILENT Technologies Ltd.
02	3DHISTECH	04	Leica

2020

#haematopath2020



www.eahp-sh2020.com

20th Meeting of the European Association for Haematopathology

Dubrovnik, Croatia
11-16 September 2020

SAVE THE DATE



Society for Hematopathology



*EUROPEAN ASSOCIATION
FOR HAEMATO*
PATHOLOGY